

TNC - TNCI



LISTA DE CÓDIGOS

CODE LIST

CODE CÓDIGO	Pág.	CODE CÓDIGO	Pág.	CODE CÓDIGO	Pág.	CODE CÓDIGO	Pág.	CODE CÓDIGO	Pág.
A-TNC-00-50	31	A-TNC-11C18-50	12	A-TNC-20C61B-75	15	A-TNC-25C26B-75-A	22	A-TNC-26C60-75	23
-00-75	31	-11C25-75	12	-20C61B-75-H	16	-25C26B-75-H	21	-26C60-75-A	25
-02-50	32	-11C25A-50	12	-20C61D-50	15	-25C27-75	20	-26C60-75-B	24
-02-50-A	32	-11C26-50	12	-20C67-75	15	-25C27-75-A	22	-26C61-75	23
-02-75	32	-11C26B-75	12	-20C67-75-H	16	-25C27-75-H	21	-26C61-75-A	25
-02-75-A	32	-11C27-75	12	-20C68-75	15	-25C27-75-B	20	-26C61-75-B	24
-03-50	31	-11C31-75	12	-20C68-75-H	16	-25C31-75-H	21	-26C61B-75	23
-03-75	31	-11C35-75	12	-20C74-75	15	-25C35-75	20	-26C61B-75-A	25
-10C16-75	9	-11C36-75	12	-20C74-75-H	16	-25C35-75-A	22	-26C61B-75-B	24
-10C16-75-H	10	-11C44A-75	12	-20C76-50	15	-25C35-75-H	21	-26C61D-50	23
-10C18-50	9	-11C45-75	12	-20C76A-50	15	-25C36-75-H	21	-26C61D-50-A	25
-10C25-75	9	-11C47-75	12	-20C77-75	15	-25C36A-75-H	21	-26C61D-50-B	24
-10C25-75-H	10	-11C50-50	12	-20C77-75-H	16	-25C39-75-H	21	-26C67-75	26
-10C25-75-B	9	-11C50A-50	12	-20P25-75	16	-25C44-75-H	21	-26C67-75-A	27
-10C25A-50	9	-11C54-50	12	-20P25A-50	16	-25C44A-75	20	-26C68-75	26
-10C26-50	9	-11C59-75	12	-20P26-50	16	-25C44A-75-A	22	-26C68-75-A	27
-10C26-50-A	9	-11C60-75	12	-20P26B-75	16	-25C44A-75-H	21	-26C74-75	26
-10C26B-75	9	-11C61-75	12	-20P50-50	16	-25C45-75	20	-26C74-75-A	27
-10C26B-75-H	10	-11C61B-75	12	-20P50A-50	16	-25C45-75-A	22	-26C84-75	26
-10C27-75	9	-11C61D-50	12	-20P54-50	16	-25C45-75-H	21	-26C84-75-A	27
-10C27-75-A	9	-11C67-75	13	-20P61-75	16	-25C47-75	20	-26C88-75	26
-10C27-75-H	10	-11C68-75	13	-20P61D-50	16	-25C47-75-A	22	-26C88-75-A	27
-10C31-75-H	10	-11C74-75	13	-22C16-75	17	-25C47-75-H	21	-26C99-50	26
-10C35-75	9	-11C84-75	13	-22C16-75-H	18	-25C50-50	20	-26C99-50-A	27
-10C35-75-H	10	-11C88-75	13	-22C18-50	17	-25C50-50-A	22	-26C101-50	26
-10C36-75-H	10	-11C99-50	13	-22C25-75	17	-25C50A-50	20	-26C101-50-A	27
-10C36A-75	9	-11C101-50	13	-22C25-75-A	17	-25C50A-50-A	22	-26C102-75	26
-10C36A-75-H	10	-11C102-75	13	-22C25-75-H	18	-25C54-50	20	-26C102-75-A	27
-10C39-75	9	-11C103-50	13	-22C25A-50	17	-25C54-50-A	22	-26C103-50	26
-10C39-75-H	10	-11C103A-75	13	-22C26-50	17	-25C59-75	20	-26C103-50-A	27
-10C44-75	9	-11C103D-50	13	-22C26-50-A	17	-25C59-75-A	22	-26C103A-75	26
-10C44-75-H	10	-11C108-50	13	-22C26B-75	17	-25C59-75-H	21	-26C103A-75-A	27
-10C44A-75	9	-11C108A-75	13	-22C26B-75-H	18	-25C60-75	20	-26C103D-50	26
-10C44A-75-H	10	-11C109-50	13	-22C27-75	17	-25C60-75-A	22	-26C103D-50-A	27
-10C45-75	9	-11P25-75	14	-22C27-75-A	17	-25C60-75-H	21	-26C108-50	26
-10C45-75-H	10	-11P25A-50	14	-22C27-75-H	18	-25C61-75	20	-26C108-50-A	27
-10C47-75	9	-11P26-50	14	-22C31-75-H	18	-25C61-75-A	22	-26C108A-75	26
-10C47-75-H	10	-11P26B-75	14	-22C35-75	17	-25C61-75-H	21	-26C108A-75-A	27
-10C50-50	9	-11P27-75	14	-22C35-75-H	18	-25C61B-75	20	-26C109-50	26
-10C50A-50	9	-11P50-50	14	-22C36-75-H	18	-25C61B-75-A	22	-26C109-50-A	27
-10C54-50	9	-11P50A-50	14	-22C36A-75-H	18	-25C61B-75-H	21	-26P25-75	28
-10C59-75	9	-11P59-75	14	-22C39-75-H	18	-25C61D-50	20	-26P25-75-A	28
-10C59-75-H	10	-11P60-75	14	-22C44-75-H	18	-25C61D-50-A	22	-26P25A-50	28
-10C60-75	9	-11P61-75	14	-22C44A-75	17	-25TF-50	29	-26P25A-50-A	28
-10C60-75-H	10	-11P61B-75	14	-22C44A-75-H	18	-25TF-50-A	29	-26P26-50	28
-10C61-75	9	-11P61D-50	14	-22C45-75	17	-25TF-75	29	-26P26-50-A	28
-10C61-75-H	10	-11P101-50	14	-22C45-75-H	18	-25TF-75-A	29	-26P26B-75	28
-10C61B-75	9	-11P102-75	14	-22C47-75	17	-26C16-75	23	-26P26B-75-A	28
-10C61B-75-H	10	-11P103-50	14	-22C47-75-H	18	-26C16-75-A	25	-26P50-50	28
-10C61D-50	9	-11P103A-75	14	-22C50-50	17	-26C16-75-B	24	-26P50-50-A	28
-10C67-75	9	-11P103D-50	14	-22C50A-50	17	-26C18-50	23	-26P50A-50	28
-10C67-75-H	10	-11P108-50	14	-22C54-50	17	-26C18-50-A	25	-26P50A-50-A	28
-10C68-75	9	-11P108A-75	14	-22C59-75	17	-26C18-50-B	24	-26P59-75	28
-10C68-75-H	10	-11P109-50	14	-22C59-75-H	18	-26C25-75	23	-26P59-75-A	28
-10C74-75	9	-15TF-50	29	-22C60-75	17	-26C25-75-A	25	-26P60-75	28
-10C74-75-H	10	-15TF-75	29	-22C60-75-H	18	-26C25-75-B	24	-26P60-75-A	28
-10C76-50	9	-20C16-75	15	-22C61-75	17	-26C25A-50	23	-26P61-75	28
-10C76-50-A	9	-20C16-75-H	16	-22C61-75-H	18	-26C25A-50-A	25	-26P61-75-A	28
-10C77-75	9	-20C18-50	15	-22C61B-75	17	-26C25A-50-B	24	-26P61B-75	28
-10C77-75-H	10	-20C25-75	15	-22C61B-75-H	18	-26C26-50	23	-26P61B-75-A	28
-10C84-75	9	-20C25-75-B	15	-22C61D-50	17	-26C26-50-A	25	-26P61D-50	28
-10C88-75	9	-20C25-75-H	16	-22C1-50	31	-26C26-50-B	24	-26P61D-50-A	28
-10C99-50	10	-20C25A-50	15	-22P25-75	19	-26C26B-75	23	-26P101-50	28
-10C101-50	10	-20C26-50	15	-22P25A-50	19	-26C26B-75-A	25	-26P102-75	28
-10C102-75	10	-20C26-50-A	15	-22P26-50	19	-26C26B-75-B	24	-26P103-50	28
-10C103-50	10	-20C26B-75	15	-22P26B-75	19	-26C27-75	23	-26P103A-75	28
-10C103A-75	10	-20C26B-75-H	16	-22P27-75	19	-26C27-75-A	25	-26P103D-50	28
-10C103D-50	10	-20C27-75	15	-22P50-50	19	-26C27-75-B	24	-26P108-50	28
-10C108-50	10	-20C27-75-A	15	-22P50A-50	19	-26C35-75	23	-26P108A-75	28
-10C108A-75	10	-20C27-75-H	16	-22P59-75	19	-26C35-75-A	25	-26P109-50	28
-10C109-50	10	-20C31-75-H	16	-22P60-75	19	-26C35-75-B	24	-26TF-50	30
-10P25-75	11	-20C35-75	15	-22P61-75	19	-26C44A-75	23	-26TF-50-A	30
-10P25A-50	11	-20C35-75-H	16	-22P61B-75	19	-26C44A-75-A	25	-26TF-75	30
-10P26-50	11	-20C36-75-H	16	-22P61D-50	19	-26C44A-75-B	24	-26TF-75-A	30
-10P26B-75	11	-20C36A-75-H	16	-22TF-50	30	-26C45-75	23	-31-50	32
-10P27-75	11	-20C39-75-H	16	-22TF-75	30	-26C45-75-A	25	-31-75	32
-10P50-50	11	-20C44-75-H	16	-23CI-50	31	-26C45-75-B	24	-40-50	33
-10P50A-50	11	-20C44A-75	15	-25C16-75	20	-26C47-75	23	-40-75	33
-10P59-75	11	-20C44A-75-H	16	-25C16-75-A	22	-26C47-75-A	25	-44-50	33
-10P60-75	11	-20C45-75	15	-25C16-75-H	21	-26C47-75-B	24	-44-75	33
-10P61-75	11	-20C45-75-H	16	-25C18-50	20	-26C50-50	23	-50-00	34
-10P61B-75	11	-20C47-75	15	-25C18-50-A	22	-26C50-50-A	25	-50-00-A	34
-10P61D-50	11	-20C47-75-H	16	-25C25-75	20	-26C50-50-B	24	-51-00	34
-10P101-50	11	-20C50-50	15	-25C25-75-A	22	-26C50A-50	23	-51-00-A	34
-10P102-75	11	-20C50A-50	15	-25C25-75-B	20	-26C50A-50-A	25	-52-50	34
-10P103-50	11	-20C54-50	15	-25C25-75-H	21	-26C50A-50-B	24	-52-50-A	34
-10P103A-75	11	-20C29-75	15	-25C25A-50	20	-26C54-50	23	-52-75	34
-10P103D-50	11	-20C59-75-H	16	-25C25A-50-A	22	-26C54-50-A	25	-52-75-A	34
-10P108-50	11	-20C60-75	15	-25C26-50	20	-26C54-50-B	24	-53-50	34
-10P108A-75	11	-20C60-75-H	16	-25C26-50-A	22	-26C59-75	23	-53-50-A	34
-10P109-50	11	-20C61-75	15	-25C26-50-B	20	-26C59-75-A	25	-53-75	34
-11C16-75	12	-20C61-75-H	16	-25C26B-75	20	-26C59-75-B	24	-53-75-A	34

LISTA DE CÓDIGOS

CODE LIST

<i>CODE</i>	
CÓDIGO	Pág.
A-TNC-54-50	35
-54-50-A	35
-54-75	35
-54-75-A	35
-55-50	35
-55-50-A	35
-55-75	35
-55-75-A	35
A-TNCI-10C18-50	39
-10C25A-50	39
-10C26-50	39
-10C50-50	39
-10C50A-50	39
-10C54-50	39
-10C61D-50	39
-15C18-50	40
-15C25A-50	40
-15C26-50	40
-15C50-50	40
-15C50A-50	40
-15C54-50	40
-15C61D-50	40
-20C18-50	37
-20C25A-50	37
-20C26-50	37
-20C50-50	37
-20C50A-50	37
-20C54-50	37
-20C61D-50	37
-20C76-50	38
-20C99-50	38
-20C101-50	38
-20C103-50	38
-20C103D-50	38
-20C108-50	38
-20C109-50	38

Interconexión	<i>Interface</i>	7
Descripción	<i>Description</i>	7,8
Características	<i>Característica</i>		
- Eléctricas	<i>Electrical</i>	8
- Mecánicas	<i>Mechanical</i>	8
- Ambientales	<i>Environmental</i>	8
Conectores para cable flexible	<i>Connectors for flexible cable</i>		
- macho crimp	<i>crimp type plug</i>		
- recto	<i>straight</i>	9,10
- 90°	<i>90°</i>	12,13
- Hembra crimp	<i>crimp type jack</i>		
- recta	<i>straight</i>	15,16,
- panel	<i>panel</i>		
- pletina cuadrada	<i>square flange</i>	17,18
- montaje frontal	<i>front mounting</i>	20...22
- montaje trasero (estanco)	<i>rear mounting (waterproof)</i>	23...27
- macho prensaestopas	<i>clamp type plug</i>		
- recto	<i>straight</i>	11
- 90°	<i>90°</i>	14
- hembra prensaestopas	<i>clamp type jack</i>		
- recta	<i>straight</i>	16
- panel	<i>panel</i>		
- pletina cuadrada	<i>square flange</i>	19
- montaje trasero (estanco)	<i>rear mounting (waterproof)</i>	28
Conectores con contacto central soldable	<i>Connectors with solder inner contact</i>		
- macho	<i>plug</i>		
- panel	<i>receptacle</i>		
- montaje frontal	<i>front mounting</i>	29
- hembra	<i>jack</i>		
- panel	<i>receptacle</i>		
- pletina cuadrada	<i>square flange</i>	30
- montaje frontal	<i>front mounting</i>	29
- montaje trasero (estanco)	<i>rear mounting (waterproof)</i>	30
Conectores para montar en circuito impreso	<i>Connectors for printed circuit board mounting</i>		
- hembra	<i>jack</i>		
- recto	<i>straight</i>	31
- 90°	<i>90°</i>	31
Adaptadores	<i>Adapters</i>		
- prolongación	<i>prolongation</i>		
- hembra-hembra	<i>jack-jack</i>	31
- macho-macho	<i>plug-plug</i>	31
- pasamuros hembra-hembra	<i>jack-jack panel adapter</i>	32
- adaptador en T	<i>T adaptor</i>		
- hembra-macho-hembra	<i>jack-plug-jack</i>	33
- hembra-hembra-hembra	<i>jack-jack-jack</i>	33
- adaptador a 90°	<i>90° adaptor</i>	32
Protectores	<i>Protectives</i>		
- tapón para hembra	<i>cap for jack</i>	34
- tapón para macho	<i>cap for plug</i>	34
Terminaciones (cargas)	<i>Terminations (loads)</i>		
- macho	<i>plug</i>		
- 50 1.000MHz 0.5W		35
- 75 1.000MHz 0.5W		35
- hembra	<i>jack</i>		
- 50 1.000MHz 0.5W		35
- 75 1.000MHz 0.5W		35

ÍNDICE *INDEX*

TNC INVERTIDO *TNC REVERSE*

Interconexión <i>Interface</i>	36
Conectores para cable flexible <i>Connectors for flexible cable</i>	
- macho crimp recto <i>straight crimp type plug</i>	
- recto <i>straight</i>	37,38
- hembra crimp <i>crimp type jack</i>	
- recta <i>straight</i>	39
- panel <i>receptacle</i>	40

**DIMENSIONES INTERCONEXIÓN
IEC 169-17**

**INTERFACE DIMENSIONS
IEC 169-17**

50 Ω

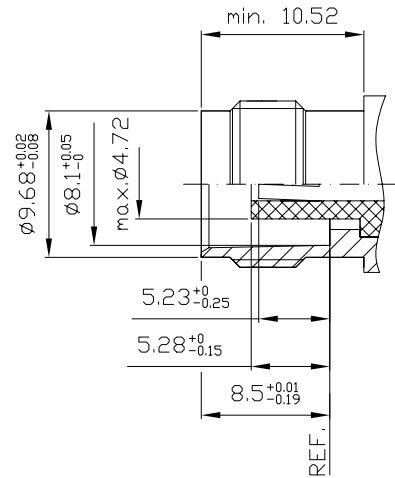
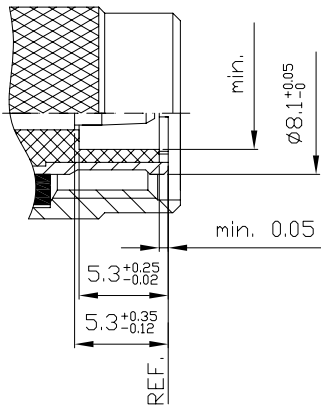

75 Ω

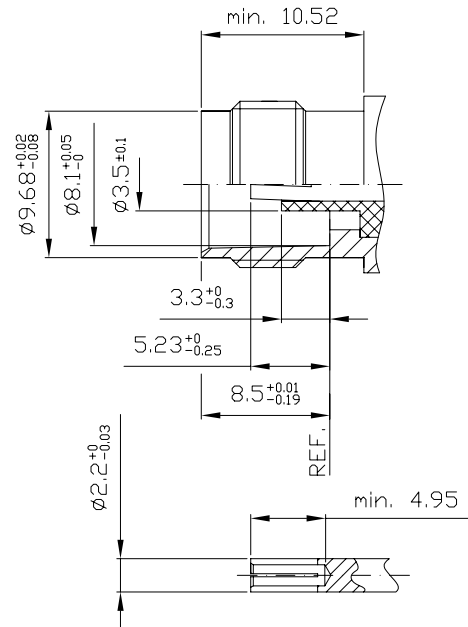
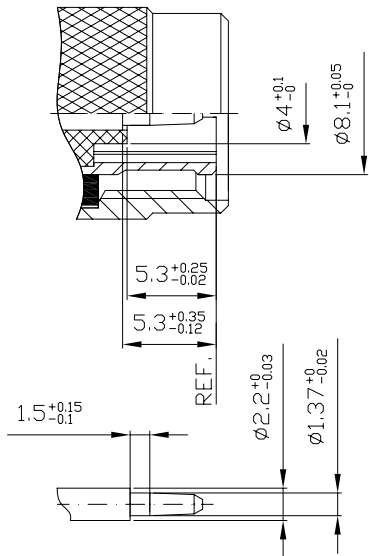

Los conectores de la serie TNC (Thread Neil Concelman) tienen un acoplamiento a rosca que los hacen más estables y fiables que la serie BNC, pueden ser utilizados en ambientes con vibraciones importantes con buenos resultados. Sus aplicaciones son múltiples: instrumentación, comunicación de datos, sistemas de seguridad, broadcast, sistemas de radio... tanto en 50 Ω como en 75 Ω, pudiéndose interconectar entre ambos. Para 50 Ω, podemos utilizarlo hasta frecuencias superiores a 11 GHz, y para 75 Ω sobrepasa 1.5 GHz con óptimos resultados de VSWR.

TNC series (Thread Neil Concelman) are connectors which have a thread coupling. They are more stable and reliable than BNC series. Besides, TNC series are useful in vibration environments, good performances are afforded. They have many applications: measurement instruments, data communication, safety systems, broadcast, radio systems,...as many 50Ω as 75Ω. Both of them can be interconnected. TNC series are useful over 11GHz for 50Ω applications, and over 1.5 GHz for 75Ω applications reaching very good VSWR results.

Contamos con un programa muy flexible de fabricación, lo cual nos permite ofrecer innumerables conectores para cables standard o especiales (flexibles, semirígidos,...).

We have a flexible manufacture program which allows us to offer a lot of versions for standard or special cables (flexible, semirigid,...)

Distintas versiones de forma: recto, acodado, panel, estanco, para circuito impreso (PCB),...Y en cuanto al montaje del cable, disponemos de versiones soldadas, prensa estopa, crimp,...

normativa: IEC 169-17.

Different shaped versions: straight, 90° angle, waterproof, panel for printed circuit board (PCB),... About cable assembly, many types are available: soldered, clamp, crimp type,...

standard: IEC 169-17.

características eléctricas / electrical characteristics	
impedancia característica / <i>characteristic impedance</i>	50 Ω or 75 Ω
margen de frecuencia utilizable (recomendado) / <i>useful frequency range (recommended)</i>	0...1.1 GHz (50 Ω) 0...1.5 GHz (75 Ω)
margen de frecuencia máximo / <i>maximum frequency range</i>	0...1.8 GHz (50 Ω) 0...4 GHz (75 Ω)
VSWR (depende de la frecuencia, del cable utilizado para el test y del tipo de conector / <i>it depends on frequency, cable used for testing and kind of connector</i>)	para un conector recto / <i>for a straight connector</i> : < 1.1 (1.5 GHz) < 1.2 (6 GHz) para un conector a 90° / <i>for a 90° connector</i> : < 1.2 (1.5 GHz) < 1.3 (6 GHz)
pérdida de inserción / <i>insertion loss</i>	< 0.1 dB (1 GHz)
RF-leakage	> 60 dB
resistencia aislante / <i>insulator resistance</i>	> 5 GΩ
resistencia contacto interior / <i>inner contact resistance</i>	< 1.5 mΩ
resistencia contacto exterior / <i>outer contact resistance</i>	< 1 mΩ
potencia máxima / <i>maximum power</i>	80 W (1GHz)
voltaje de trabajo / <i>working voltage</i>	500 Vrms
voltaje de pico / <i>peak voltage</i>	1500 Vrms

características mecánicas / mechanical characteristics	
durabilidad / <i>durability</i>	> 500 ciclos conexión / > 500 <i>matings</i>
par aplicable al racord / <i>coupling nut torque</i>	10...25 Ncm
material aislante / <i>insulator material</i>	PTFE
material contactos interiores / <i>inner contacts material</i> .	macho / <i>male</i> : CuZn39Pb3 hembra / <i>female</i> : CuBe2
material cuerpos exteriores / <i>outer bodies material</i>	CuZn39Pb3
juntas estanqueidad / <i>gaskets</i>	silicona / <i>silicone</i>
acabados / <i>finish plating</i>	cuerpos exteriores / <i>outer bodies</i> : Ni 5μ contactos interiores / <i>inner contacts</i> : Au 1μ

características ambientales / environmental characteristics	
margen de temperatura / <i>temperature range</i>	-65°C...+165°C
categoría climática IEC / <i>IEC climatic category</i>	55/155/21
choque térmico / <i>thermal shock</i>	MIL-STD-202/107-B
resistencia a la humedad / <i>moisture resistance</i>	MIL-STD-202/106-B
resistencia a la corrosión / <i>corrosion resistance</i>	MIL-STD-202/101-B
resistencia a la vibración / <i>vibration resistance</i>	MIL-STD-202/204-B

Conectores para cable flexible
macho recto crimp

Connectors for flexible cable
straight crimp type plug

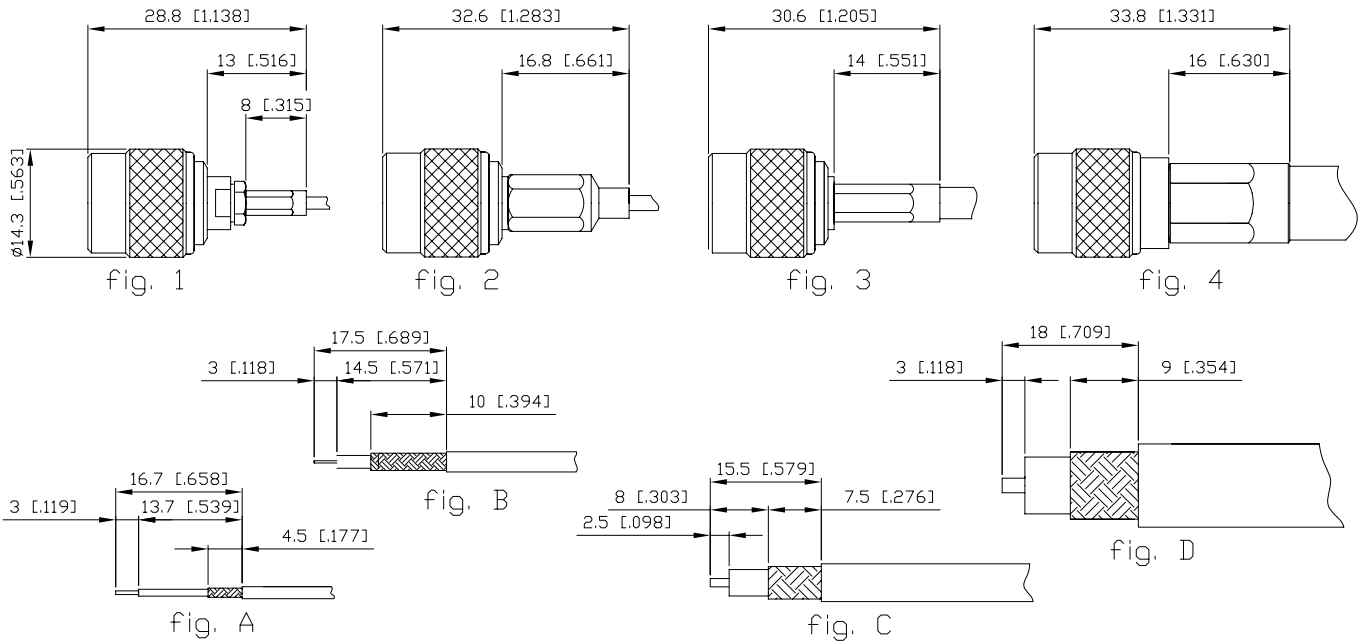

CABLE CABLE	INSTRUC. INSTRUC.	Ω	ALFA'R CODE CÓDIGO ALFA'R	FIG. FIG.	CRIMPING TOOL HERRAMIENTA CRIMP	
TX-20	INS 8	75	A-TNC-10C16-75	1 A	A-EIN-C-1-C61	
RG-178; RG-196		50	A-TNC-10C18-50			
RG-179	INS 36	75	A-TNC-10C25-75	2 B	A-EIN-C-1-641	
		--	A-TNC-10C25-75-B			
RG-316	INS 8	50	A-TNC-10C25A-50	1 A	A-EIN-C-1-641	
RG-174; RG-188	INS 36	--	A-TNC-10C26-50-A	2 B	A-EIN-C-1-931	
RG-187; TZX-75101	INS 8	75	A-TNC-10C26B-75	1 A	A-EIN-C-1-641	
FLEX-2	INS 36	--	A-TNC-10C27-75			
		--	A-TNC-10C27-75-A	2 B		
FLEX-3	INS 9	75	A-TNC-10C35-75	3 C	A-EIN-C-1-931	
TZX-75024; CM-195 DM; L910-34			A-TNC-10C36A-75			
L910-39			A-TNC-10C39-75			
0.6-2.8; VK-5			A-TNC-10C44-75			
S 0.4/2.5			A-TNC-10C44A-75			
FLEX-4			A-TNC-10C45-75			
FLEX-5			A-TNC-10C47-75			
RG-58; RG-141; RG-303		50	A-TNC-10C50-50		A-EIN-C-1-931 A-EIN-C-1-341	
RG-142; RG-400			A-TNC-10C50A-50			
RG-223			A-TNC-10C54-50			
ST-214		75	A-TNC-10C59-75			A-EIN-C-1-51
FLEX-6			A-TNC-10C60-75			
RG-59			A-TNC-10C61-75			
0.8-0.7; 1505A; 9889; VK-6		50	A-TNC-10C61B-75			
LMR-240	A-TNC-10C61D-50					
TF-2240	75	A-TNC-10C67-75				
RG-6 CATV		A-TNC-10C68-75				
FLEX-7	50	A-TNC-10C74-75				
5D-FB		A-TNC-10C76-50				
LMR-300		A-TNC-10C76A-50				
VK-49		A-TNC-10C77-75				
RG-6 MIL		75	A-TNC-10C84-75			
1.0/6.6/8.8			A-TNC-10C88-75			

macho recto crimp

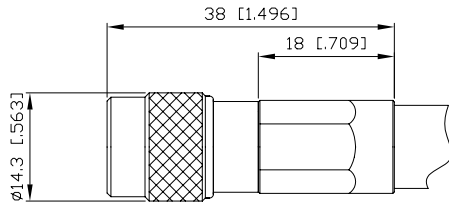

straight crimp type plug

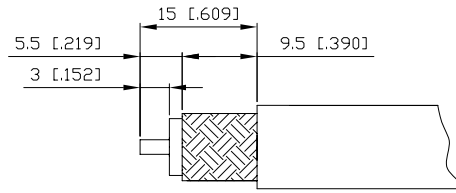

CABLE CABLE	INSTRUC. INSTRUC.	Ω	ALFA'R CODE CÓDIGO ALFA'R	CRIMPING TOOL HERRAMIENTA CRIMP	
RG-393	INS 10	50	A-TNC-10C99-50	A-EIN-C-2-D2	
RG-8			A-TNC-10C101-50		
CATV 14/8		75	A-TNC-10C102-75		A-EIN-C-2-D1
RG-213		50	A-TNC-10C103-50		A-EIN-C-2-D2
RG-11		75	A-TNC-10C103A-75		A-EIN-C-2-D1
LMR-400; RG-165		50	A-TNC-10C103D-50		A-EIN-C-2-D2
RG-214		A-TNC-10C108-50			
RG-216		75	A-TNC-10C108A-75		A-EIN-C-2-D1
RG-225		50	A-TNC-10C109-50		A-EIN-C-2-D2

macho crimp HD-3GHz 75 Ω

crimp type plug HD-3GHz 75 Ω

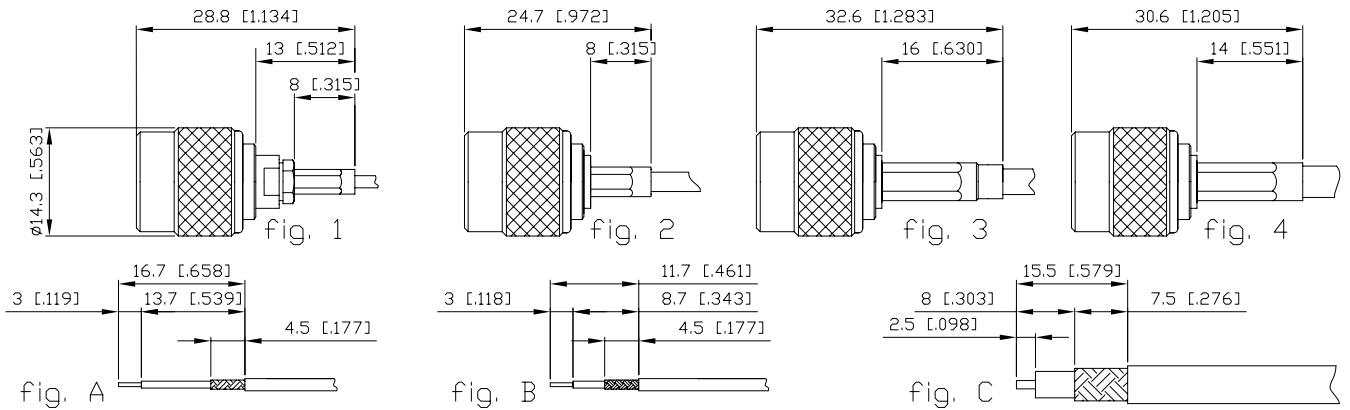

CABLE CABLE	INSTRUC. INSTRUC.	ALFA'R CODE CODIGO ALFA'R	FIG. FIG.	CRIMPING TOOL HERRAMIENTA CRIMP
TX-20	INS 08	A-TNC-10C16-75-H	1 A	A-EIN-C-1-C6K
RG179	INS 09	A-TNC-10C25-75-H	2 B	
RG187		A-TNC-10C26B-75-H		
FLEX-2		A-TNC-10C27-75-H	3	A-EIN-C-1-96K
ST-212	A-TNC-10C31-75-H			
FLEX-3	A-TNC-10C35-75-H			
BT-3002	A-TNC-10C36-75-H	4 C	A-EIN-C-1-93K	
TZC-75024; CM-195 DM; L910-34	A-TNC-10C36A-75-H			
L910-39	A-TNC-10C39-75-H			
0.6/2.8; VK-5	A-TNC-10C44-75-H	4 C	A-EIN-C-1-43K	
S 0.4/2.5	A-TNC-10C44A-75-H			
FLEX-4	A-TNC-10C45-75-H			
FLEX-5	A-TNC-10C47-75-H	4 C	A-EIN-C-1-43K	
ST-214	A-TNC-10C59-75-H			
FLEX-6	A-TNC-10C60-75-H			
RG-59	A-TNC-10C61-75-H	4 C	A-EIN-C-1-5K	
0.8/0.7; 1505A; 9889; VK-6	A-TNC-10C61B-75-H			
TF-2240	A-TNC-10C67-75-H			
RG-6 CATV	A-TNC-10C68-75-H	4 C	A-EIN-C-1-5K	
FLEX-7	A-TNC-10C74-75-H			
VK-49	A-TNC-10C77-75-H			

macho recto prensaestopas

straight clamp type plug

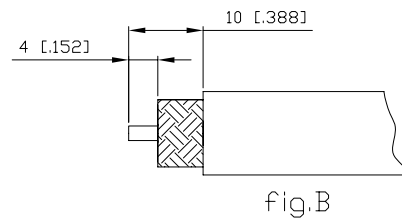
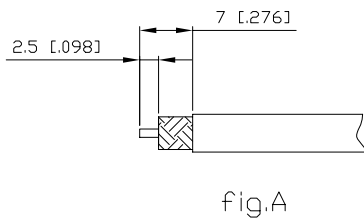
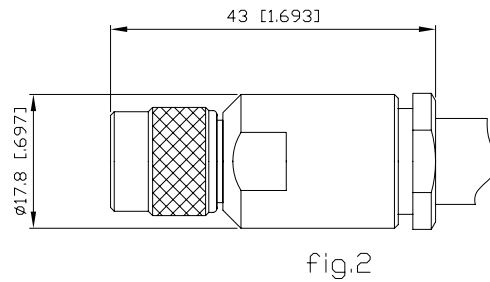
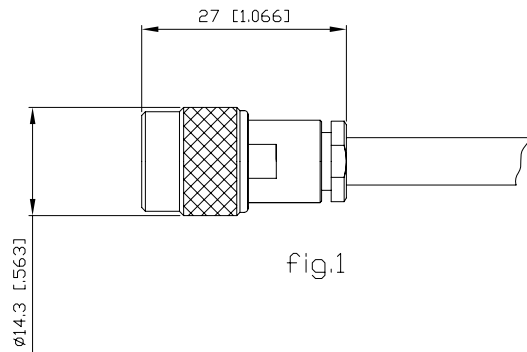

CABLE	INSTRUC.	Ω	ALFA'R CODE	FIG.	SPANNER			
CABLE	INSTRUC.		CÓDIGO ALFA'R	FIG.	LLAVE FIJA			
RG-179	INS 12	75	A-TNC-10P25-75	1	A			
RG-316		50	A-TNC-10P25A-50					
RG-174; RG-188			A-TNC-10P26-50					
RG-187		75	A-TNC-10P26B-75					
FLEX-2			A-TNC-10P27-75					
RG-58; RG-141; RG-303		50	A-TNC-10P50-50					
RG-142; RG-400			A-TNC-10P50A-50					
ST-214		75	A-TNC-10P59-75					
FLEX-6			A-TNC-10P60-75					
RG-59			A-TNC-10P61-75					
Three Shield $\phi 6.1$			A-TNC-10P61B-75					
LMR-240			A-TNC-10P61D-50					
RG-8		INS 13	50			A-TNC-10P101-50	2	B
CATV 14/8			75			A-TNC-10P102-75		
RG-213	50		A-TNC-10P103-50					
RG-11	75		A-TNC-10P103A-75					
LMR-400; RG-165	50		A-TNC-10P103D-50					
RG-214			A-TNC-10P108-50					
RG-216	75		A-TNC-10P108A-75					
RG-225	50		A-TNC-10P109-50					

macho 90° crimp

90° crimp type plug

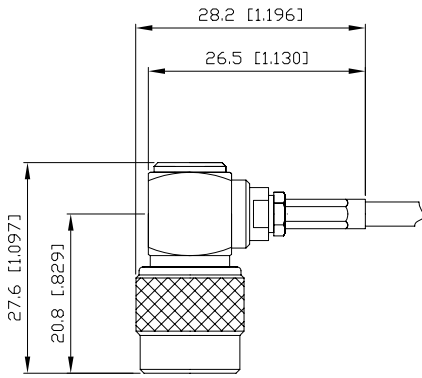

fig.1

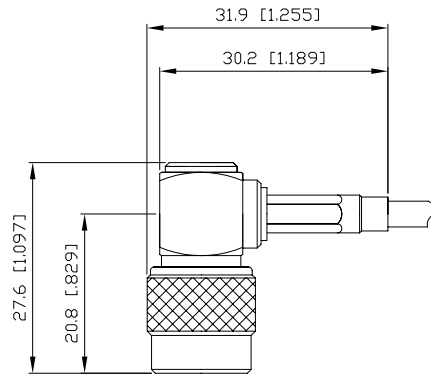

fig.2

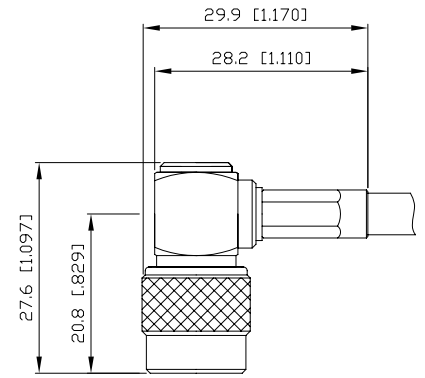

fig.3

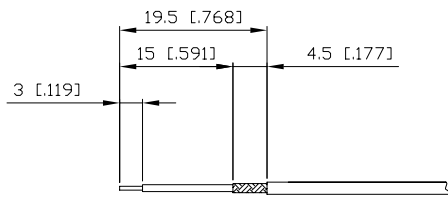

fig.A

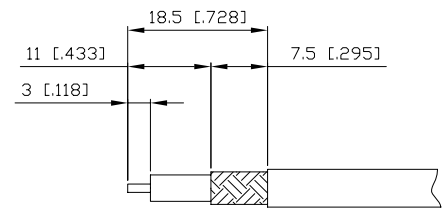

fig.B

CABLE	INSTRUC.	Ω	ALFA'R CODE	FIG.	CRIMPING TOOL
CABLE	INSTRUC.		CÓDIGO ALFA'R	FIG.	HERRAMIENTA CRIMP
TX-20	INS 8	75	A-TNC-11C16-75	1	A
RG-178; RG-196		50	A-TNC-11C18-50		
RG-179		75	A-TNC-11C25-75		
RG-316		50	A-TNC-11C25A-50		
RG-174; RG-188			A-TNC-11C26-50		
RG-187			A-TNC-11C26B-75		
FLEX-2			A-TNC-11C27-75		
ST-212	75	A-TNC-11C31-75	2	B	
FLEX-3		A-TNC-11C35-75			
BT-3002		A-TNC-11C36-75			
S 0.4/2.5		A-TNC-11C44A-75			
FLEX-4		A-TNC-11C45-75			
FLEX-5		A-TNC-11C47-75			
RG-58; RG-141; RG-303		INS 11			50
RG-142; RG-400	A-TNC-11C50A-50				
RG-223	A-TNC-11C54-50				
ST-214	A-TNC-11C59-75				
FLEX-6	75	A-TNC-11C60-75	3	B	
RG-59		A-TNC-11C61-75			
Three Shield ϕ 6.1		A-TNC-11C61B-75			
LMR-240		A-TNC-11C61D-50			

macho 90° crimp

90° crimp type plug

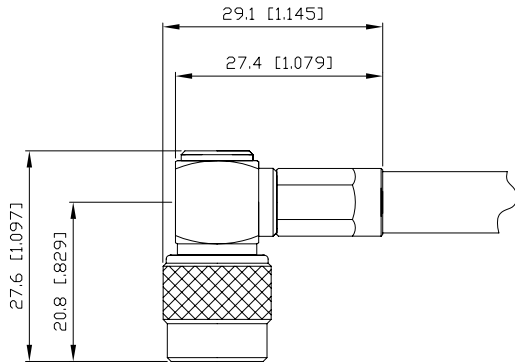

fig.1

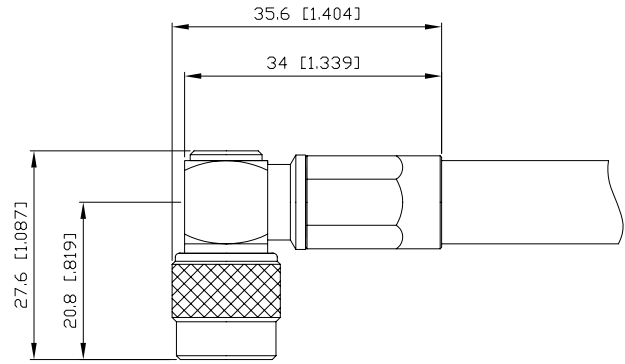

fig.2

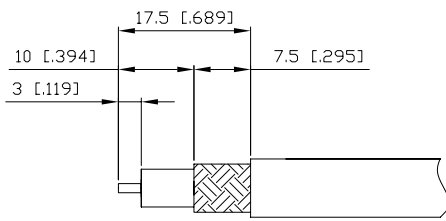

fig.A

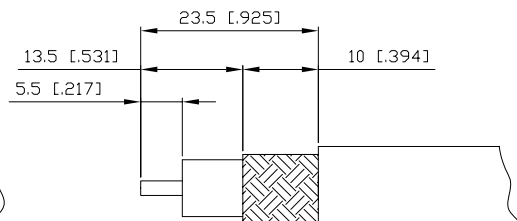
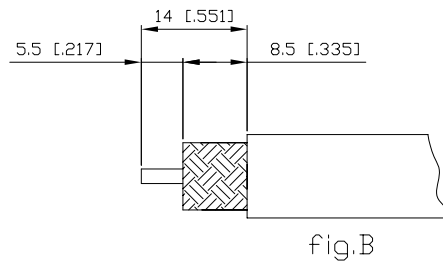
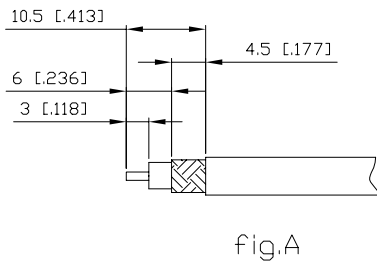
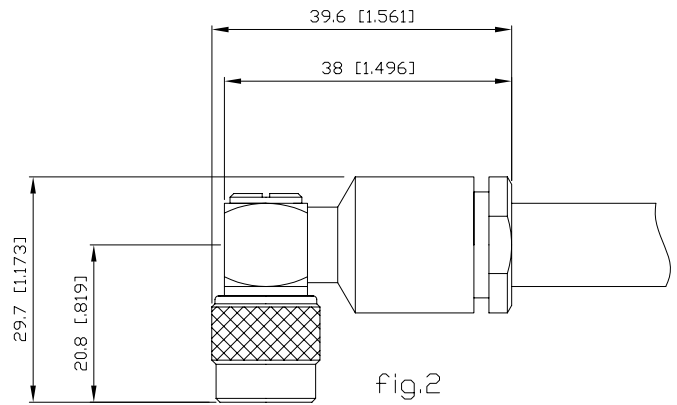
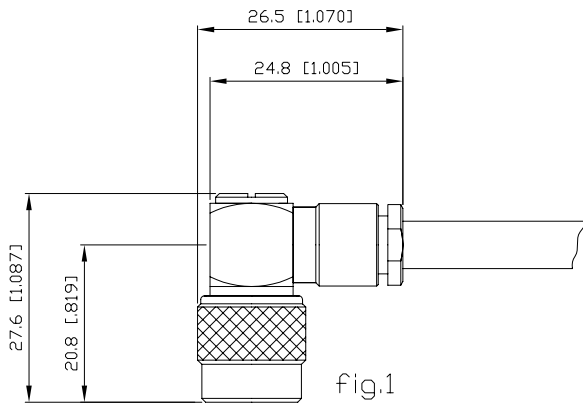

fig.B

CABLE	INSTRUC.	Ω	ALFA'R CODE CÓDIGO ALFA'R	FIG.	CRIMPING TOOL HERRAMIENTA CRIMP
TF-2240 (TFC-T10)	INS 11	75	A-TNC-11C67-75	1	A
RG-6 CATV			A-TNC-11C68-75		
FLEX-7			A-TNC-11C74-75		
RG-6 MIL			A-TNC-11C84-75		
1.0/6.6/8.8			A-TNC-11C88-75		
RG-393		50	A-TNC-11C99-50	2	B
RG-8		50	A-TNC-11C101-50		
CATV 14/8		75	A-TNC-11C102-75		
RG-213		50	A-TNC-11C103-50		
RG-11		75	A-TNC-11C103A-75		
LMR-400; RG-165		50	A-TNC-11C103D-50		
RG-214		50	A-TNC-11C108-50		
RG-216		75	A-TNC-11C108A-75		
RG-225		50	A-TNC-11C109-50		

macho 90° prensaestopas

90° clamp type plug



CABLE	INSTRUC.	Ω	ALFA'R CODE	FIG.
CABLE	INSTRUC.		CÓDIGO ALFA'R	FIG.
RG-179	INS 14	75	A-TNC-11P25-75	1 A
RG-316		50	A-TNC-11P25A-50	
RG-174; RG-188			A-TNC-11P26-50	
RG-187		75	A-TNC-11P26B-75	
FLEX-2			A-TNC-11P27-75	
RG-58; RG-141; RG-303		50	A-TNC-11P50-50	
RG-142; RG-400			A-TNC-11P50A-50	
ST-214		75	A-TNC-11P59-75	
FLEX-6			A-TNC-11P60-75	
RG-59			A-TNC-11P61-75	
Three Shield $\phi 6.1$			A-TNC-11P61B-75	
LMR-240		50	A-TNC-11P61D-50	2 B
RG-8			A-TNC-11P101-50	
CATV 14/8		75	A-TNC-11P102-75	
RG-213		50	A-TNC-11P103-50	
RG-11		75	A-TNC-11P103A-75	
LMR-400; RG-165		50	A-TNC-11P103D-50	
RG-214			A-TNC-11P108-50	
RG-216		75	A-TNC-11P108A-75	
RG-225		50	A-TNC-11P109-50	

hembra recta crimp

straight crimp type jack

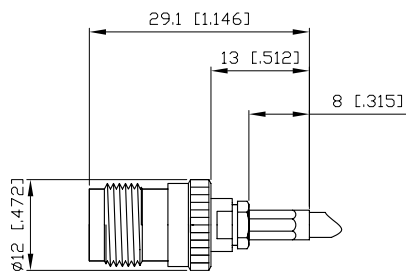

fig. 1

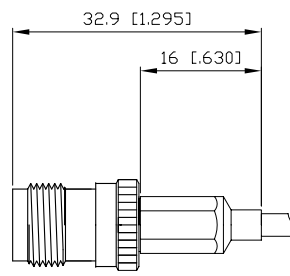

fig. 2

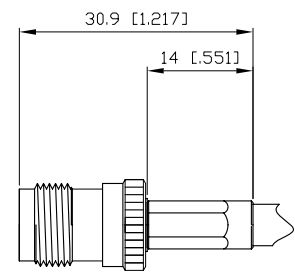

fig. 3

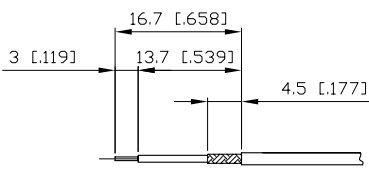

fig. A

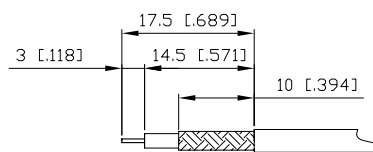

fig. B

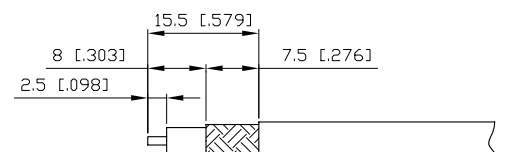
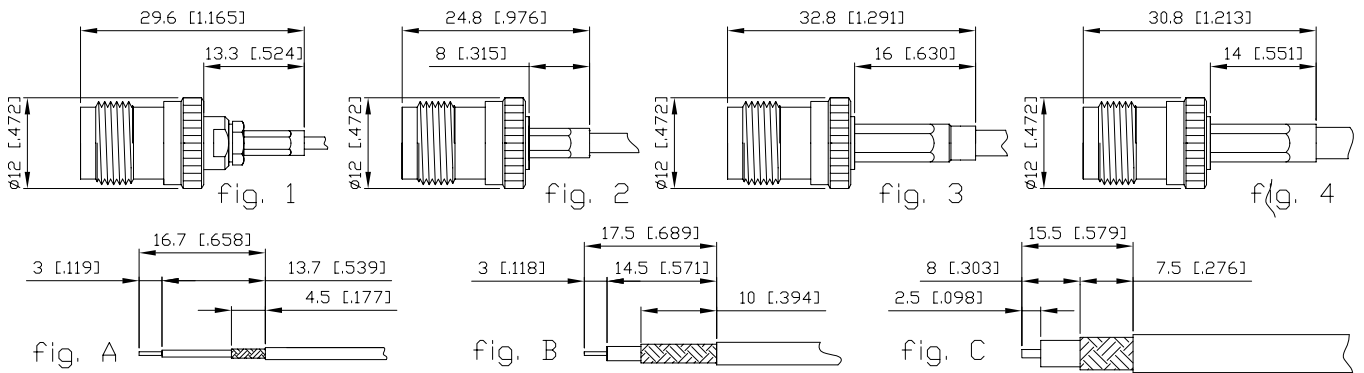

fig. C

CABLE CABLE	INSTRUC. INSTRUC.	Ω	ALFA'R CODE CÓDIGO ALFA'R	FIG. FIG.	CRIMPING TOOL HERRAMIENTA CRIMP	
TX-20	INS 8	75	A-TNC-20C16-75	1 A	A-EIN-C-1-C61	
RG-178; RG-196		50	A-TNC-20C18-50			
RG-179		75	A-TNC-20C25-75			
RG-316	INS 36	--	A-TNC-20C25-75-B	2 B	A-EIN-C-1-931	
RG-174; RG-188	INS 8	50	A-TNC-20C25A-50	1 A	A-EIN-C-1-641	
RG-187			A-TNC-20C26-50			
FLEX-2	INS 36	--	A-TNC-20C26-50-A	2 B	A-EIN-C-1-931	
FLEX-3	INS 8	75	A-TNC-20C26B-75	1 A	A-EIN-C-1-641	
S 0.4/2.5						A-TNC-20C27-75
FLEX-4						A-TNC-20C27-75-A
FLEX-5	INS 36	--	A-TNC-20C27-75-A	2 B	A-EIN-C-1-931	
RG-58; RG-141; RG-303	INS 9	50	A-TNC-20C35-75	3 C		
RG-142; RG-400						A-TNC-20C44A-75
RG-223						A-TNC-20C45-75
ST-214						A-TNC-20C47-75
FLEX-6						A-TNC-20C50-50
RG-59						A-TNC-20C50A-50
0.8-0.7; 1005A; 9889; VK-6		75	A-TNC-20C54-50			
LMR-240			A-TNC-20C59-75			
TF-2240			A-TNC-20C60-75			
RG-6 CATV			A-TNC-20C61-75			
FLEX-7			A-TNC-20C61B-75			
5D-FB			A-TNC-20C61D-50			
LMR-300			A-TNC-20C67-75			
VK-49			A-TNC-20C68-75			
			A-TNC-20C74-75			
			A-TNC-20C76-50			
			A-TNC-20C76A-50			
			A-TNC-20C77-75			
				A-EIN-C-1-51		

hembra crimp HD-3GHz 75Ω

crimp type jack HD-3GHz 75Ω



CABLE CABLE	INSTRUC. INSTRUC.	ALFA'R CODE CÓDIGO ALFA'R	FIG. FIG.	CRIMPING TOOL HERRAMIENTA CRIMP
TX-20	INS 08	A-TNC-20C16-75-H	1 A	A-EIN-C-1-C6K
RG179	INS 09	A-TNC-20C25-75-H	2 B	
RG187		A-TNC-20C26B-75-H		
FLEX-2		A-TNC-20C27-75-H	3	A-EIN-C-1-96K
ST-212		A-TNC-20C31-75-H		
FLEX-3		A-TNC-20C35-75-H		
BT-3002		A-TNC-20C36-75-H	4 C	A-EIN-C-1-93K
TZC-75024; CM-195 DM; L910-34		A-TNC-20C36A-75-H		
L910-39		A-TNC-20C39-75-H		
0.6/2.8; VK-5		A-TNC-20C44-75-H		
S 0.4/2.5		A-TNC-20C44A-75-H		
FLEX-4		A-TNC-20C45-75-H		
FLEX-5		A-TNC-20C47-75-H		A-EIN-C-1-43K
ST-214	A-TNC-20C59-75-H			
FLEX-6	A-TNC-20C60-75-H			
RG-59	A-TNC-20C61-75-H			
0.8/0.7; 1505A; 9889; VK-6	A-TNC-20C61B-75-H			
TF-2240	A-TNC-20C67-75-H			
RG-6 CATV	A-TNC-20C68-75-H	A-EIN-C-1-5K		
FLEX-7	A-TNC-20C74-75-H			
VK-49	A-TNC-20C77-75-H			

hembra recta prensaestopas

straight clamp type jack

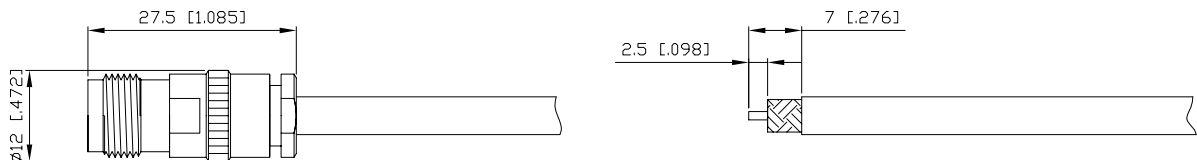

CABLE CABLE	INSTRUC. INSTRUC.	Ω	ALFA'R CODE CÓDIGO ALFA'R
RG-179	INS 12	75	A-TNC-20P25-75
RG-316		50	A-TNC-20P25A-50
RG-174; RG-188			A-TNC-20P26-50
RG-187		75	A-TNC-20P26B-75
RG-58; RG-141; RG-303		50	A-TNC-20P50-50
RG-142; RG-400			A-TNC-20P50A-50
RG-223			A-TNC-20P54-50
RG-59		75	A-TNC-20P61-75
LMR-240		50	A-TNC-20P61D-50

hembra recta panel crimp
(pletina cuadrada)

straight crimp type jack panel
(square flange)

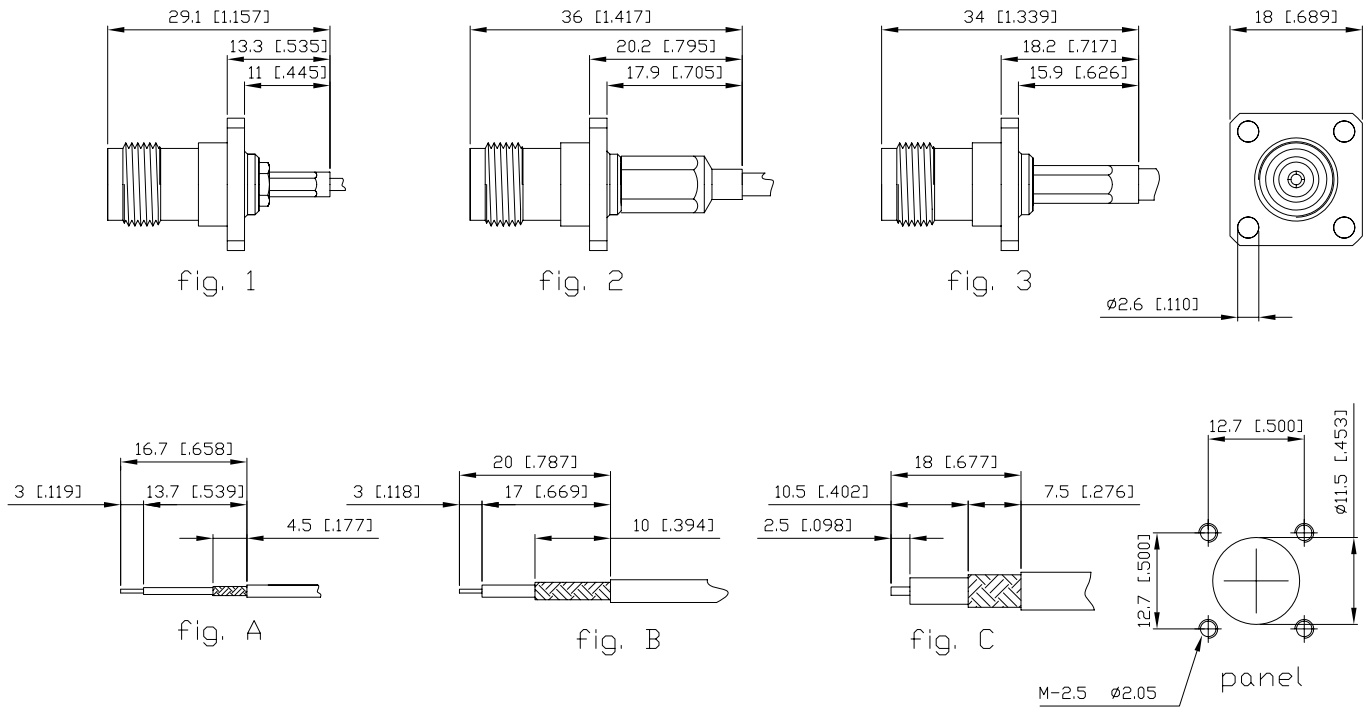

CABLE CABLE	INSTRUC. INSTRUC.	Ω	ALFA'R CODE CÓDIGO ALFA'R	FIG. FIG.	CRIMPING TOOL HERRAMIENTA CRIMP
TX-20	INS 8	75	A-TNC-22C16-75	1	A
RG-178; RG-196		50	A-TNC-22C18-50		
RG-179	INS 36	75	A-TNC-22C25-75	2	B
		--	A-TNC-22C25-75-A		
RG-316	INS 8	50	A-TNC-22C25A-50	1	A
RG-174; RG-188	INS 36	--	A-TNC-22C26-50	2	B
		--	A-TNC-22C26-50-A		
RG-187	INS 8	75	A-TNC-22C26B-75	1	A
FLEX-2	INS 36	--	A-TNC-22C27-75	2	B
		--	A-TNC-22C27-75-A		
FLEX-3	INS 9	75	A-TNC-22C35-75	3	C
S 0.4/2.5			A-TNC-22C44A-75		
FLEX-4			A-TNC-22C45-75		
FLEX-5			A-TNC-22C47-75		
RG-58; RG-141; RG-303	INS 9	50	A-TNC-22C50-50	3	C
RG-142; RG-400			A-TNC-22C50A-50		
RG-223			A-TNC-22C54-50		
ST-214			A-TNC-22C59-75		
FLEX-6	INS 9	75	A-TNC-22C60-75	3	C
RG-59			A-TNC-22C61-75		
Three Shield ϕ 6.1			A-TNC-22C61B-75		
LMR-240			A-TNC-22C61D-50		

hembra crimp HD-3GHz 75Ω
(pletina cuadrada)

crimp type jack HD-3GHz 75Ω
(square flange)

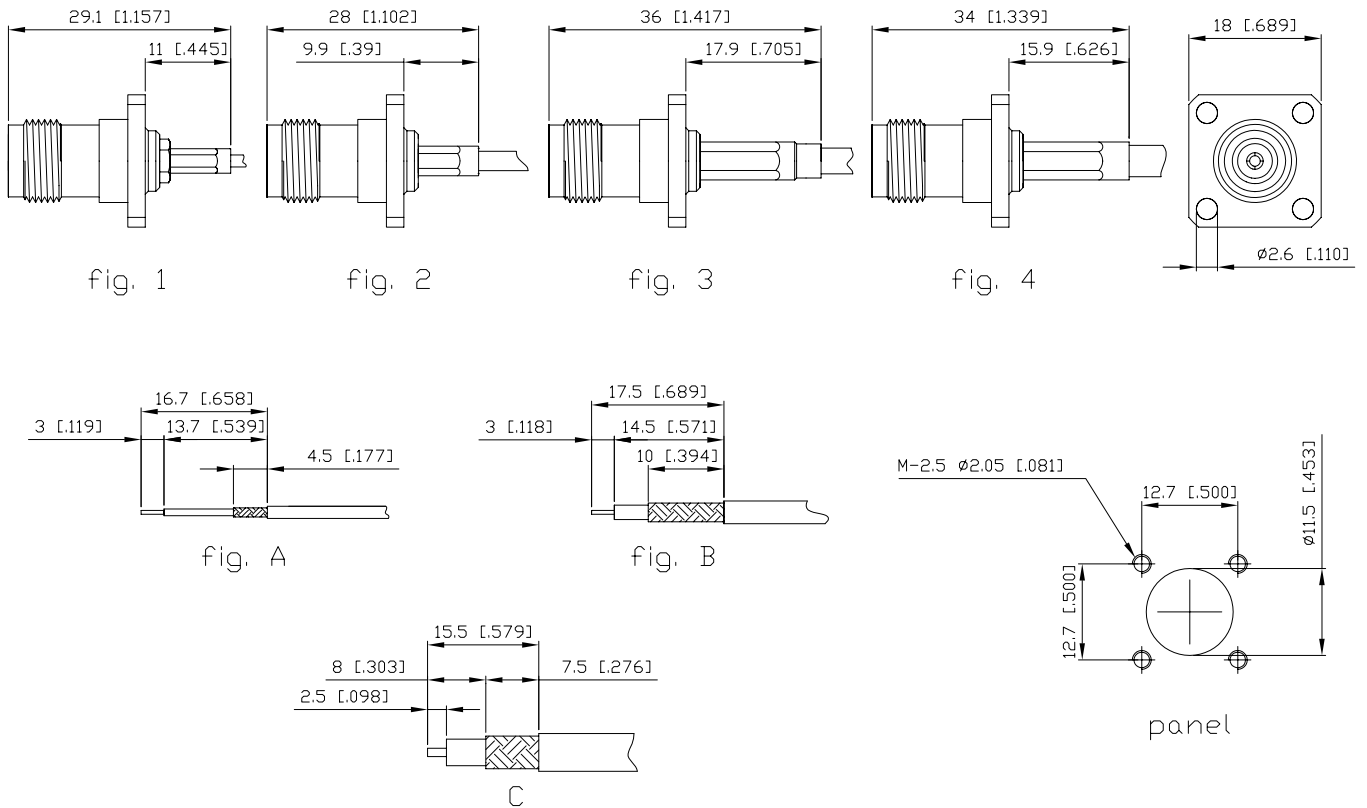

CABLE	INSTRUC.	ALFA'R CODE	FIG.	CRIMPING TOOL
CABLE	INSTRUC.	CODIGO ALFA'R	FIG.	HERRAMIENTA CRIMP
TX-20	INS 08	A-TNC-22C16-75-H	1	A-EIN-C-1-C6K
RG179	INS 09	A-TNC-22C25-75-H	2	
RG187		A-TNC-22C26B-75-H		
FLEX-2		A-TNC-22C27-75-H	3	A-EIN-C-1-96K
ST-212		A-TNC-22C31-75-H		
FLEX-3		A-TNC-22C35-75-H	4	C
BT-3002		A-TNC-22C36-75-H		
TZC-75024; CM-195 DM; L910-34		A-TNC-22C36A-75-H		
L910-39		A-TNC-22C39-75-H		
0.6/2.8; VK-5		A-TNC-22C44-75-H		
S 0.4/2.5		A-TNC-22C44A-75-H		
FLEX-4		A-TNC-22C45-75-H		
FLEX-5		A-TNC-22C47-75-H		
ST-214	A-TNC-22C59-75-H			
FLEX-6	A-TNC-22C60-75-H			
RG-59	A-TNC-22C61-75-H			
0.8/0.7; 1505A; 9889; VK-6	A-TNC-22C61B-75-H			

hembra recta panel prensaestopas
(pletina cuadrada)

straight clamp type jack panel
(square flange)

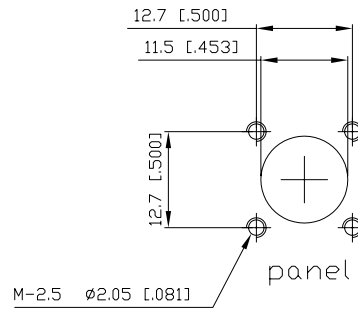
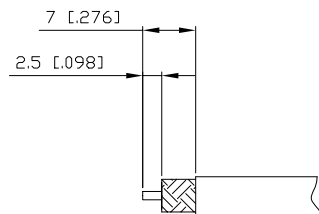
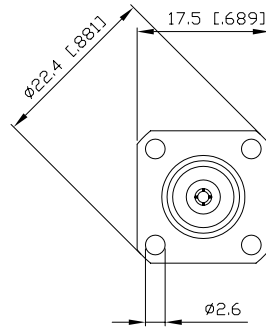
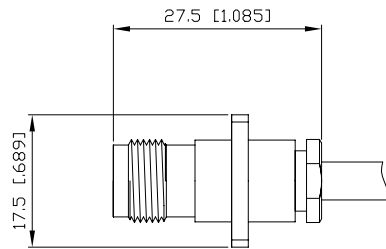

CABLE	INSTRUC.	Ω	ALFA'R CODE		
CABLE	INSTRUC.		CODIGO ALFA'R		
RG-179	INS 12	75	A-TNC-22P25-75		
RG-316		50	A-TNC-22P25A-50		
RG-174; RG-188				A-TNC-22P26-50	
RG-187		75	A-TNC-22P26B-75		
FLEX-2				A-TNC-22P27-75	
RG-58; RG-141; RG-303		50	A-TNC-22P50-50		
RG-142; RG-400				A-TNC-22P50A-50	
ST-214				A-TNC-22P59-75	
FLEX-6		75		A-TNC-22P60-75	
RG-59				A-TNC-22P61-75	
Three Shield $\phi 6.1$				A-TNC-22P61B-75	
LMR-240			50	A-TNC-22P61D-50	

hembra recta panel crimp
(montaje frontal)

straight crimp type bulkhead jack
(front mounting)

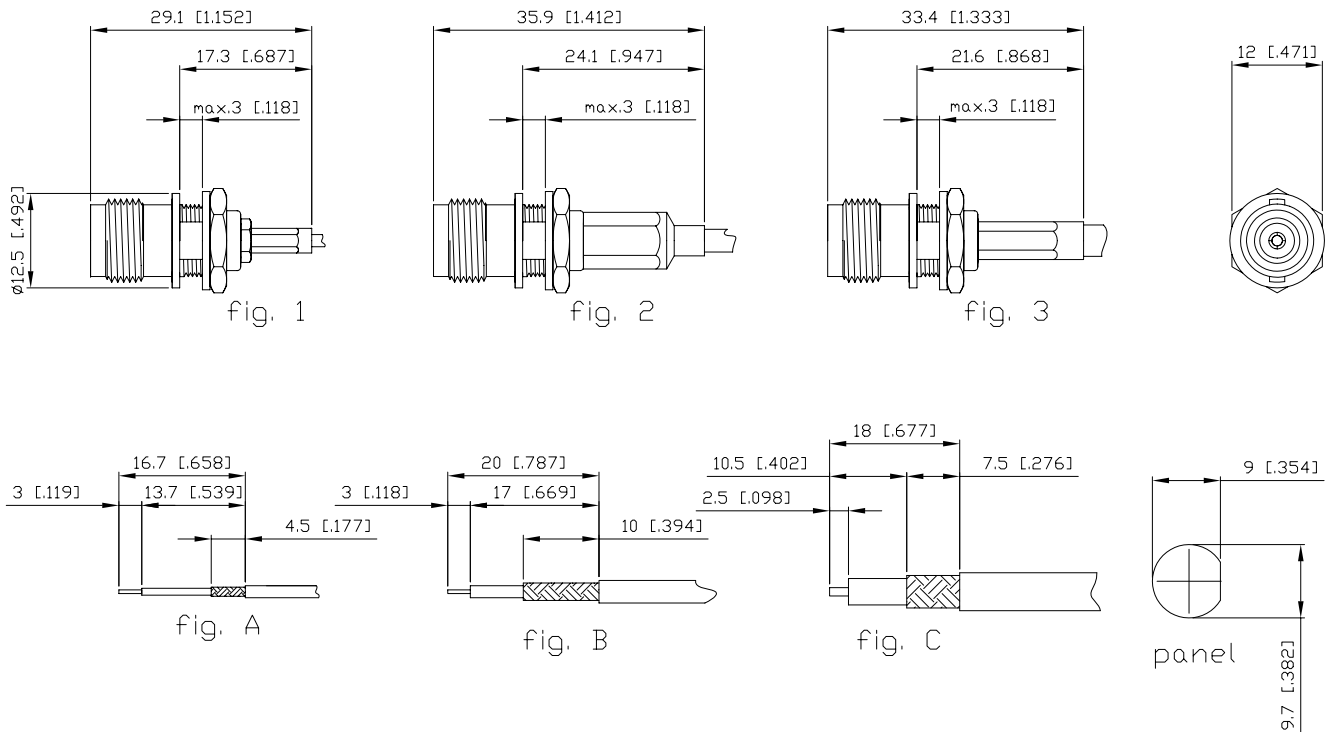

CABLE CABLE	INSTRUC. INSTRUC.	Ω	ALFA'R CODE CÓDIGO ALFA'R	FIG. FIG.	CRIMPING TOOL HERRAMIENTA CRIMP
TX-20	INS 8	75	A-TNC-25C16-75	1 A	A-EIN-C-1-C61
RG-178; RG-196		50	A-TNC-25C18-50		
		75	A-TNC-25C25-75		
RG-179	INS 36	--	A-TNC-25C25-75-B	2 B	A-EIN-C-1-931
RG-316	INS 8	50	A-TNC-25C25A-50	1 A	A-EIN-C-1-641
RG-174; RG-188			A-TNC-25C26-50		
	INS 36	--	A-TNC-25C26-50-B	2 B	A-EIN-C-1-931
RG-187	INS 8	75	A-TNC-25C26B-75	1 A	A-EIN-C-1-641
FLEX-2	INS 36	--	A-TNC-25C27-75	2 B	A-EIN-C-1-931
			A-TNC-25C27-75-B		
FLEX-3	INS 9	75	A-TNC-25C35-75	3 C	A-EIN-C-1-931
S 0.4/2.5			A-TNC-25C44A-75		
FLEX-4			A-TNC-25C45-75		
FLEX-5			A-TNC-25C47-75		
RG-58; RG-141; RG-303	INS 9	50	A-TNC-25C50-50	3 C	A-EIN-C-1-931 A-EIN-C-1-341
RG-142; RG-400			A-TNC-25C50A-50		
RG-223			A-TNC-25C54-50		
ST-214			A-TNC-25C59-75		
FLEX-6	INS 9	75	A-TNC-25C60-75	3 C	A-EIN-C-1-931 A-EIN-C-1-341
RG-59			A-TNC-25C61-75		
0.8-0.7; 1505A; 9889; VK-6			A-TNC-25C61B-75		
LMR-240			A-TNC-25C61D-50		

hembra recta panel crimp
HD-3GHz 75Ω (montaje frontal)

straight crimp type bulkhead jack
HD-3 GHz 75Ω (front mounting)

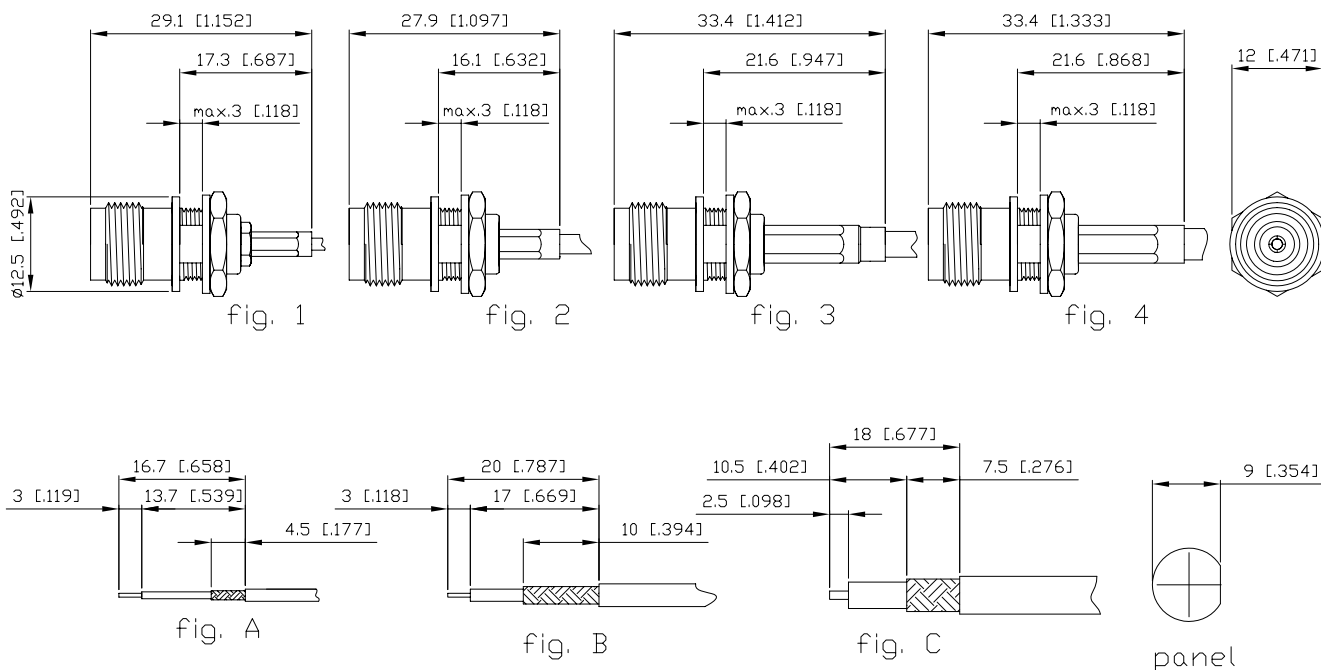

CABLE	INSTRUC.	ALFA'R CODE	FIG.	CRIMPING TOOL		
CABLE	INSTRUC.	CODIGO ALFA'R	FIG.	HERRAMIENTA CRIMP		
TX-20	INS 08	A-TNC-25C16-75-H	1	A-EIN-C-1-C6K		
RG179	INS 09	A-TNC-25C25-75-H	2			
RG187		A-TNC-25C26B-75-H				
FLEX-2		A-TNC-25C27-75-H	3	A-EIN-C-1-96K		
ST-212		A-TNC-25C31-75-H				
FLEX-3		A-TNC-25C35-75-H				
BT-3002		A-TNC-25C36-75-H				
TZC-75024; CM-195 DM; L910-34		A-TNC-25C36A-75-H				
L910-39		A-TNC-25C39-75-H				
0.6/2.8; VK-5		A-TNC-25C44-75-H			4	A-EIN-C-1-93K
S 0.4/2.5		A-TNC-25C44A-75-H				
FLEX-4	A-TNC-25C45-75-H					
FLEX-5	A-TNC-25C47-75-H					
ST-214	A-TNC-25C59-75-H	4	A-EIN-C-1-43K			
FLEX-6	A-TNC-25C60-75-H					
RG-59	A-TNC-25C61-75-H					
0.8/0.7; 1505A; 9889; VK-6		A-TNC-25C61B-75-H				

hembra recta larga
panel crimp
(montaje frontal)

long straight crimp
type bulkhead jack
(front mounting)

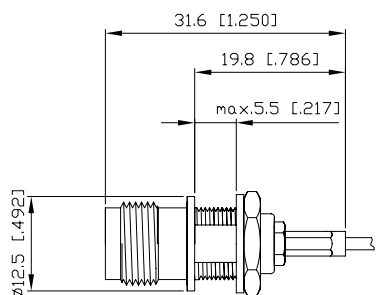

fig.1

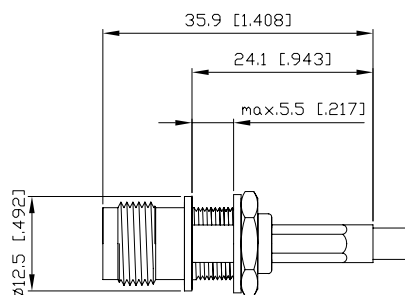

fig.2

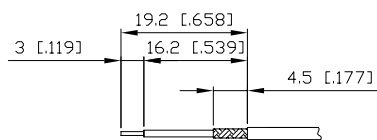
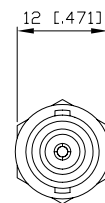

fig.A

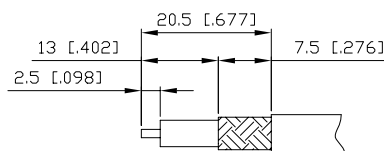
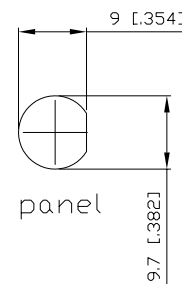

fig.B



panel

CABLE CABLE	INSTRUC. INSTRUC.	Ω	ALFA'R CODE CÓDIGO ALFA'R	FIG. FIG.	CRIMPING TOOL HERRAMIENTA CRIMP	
TX-20	INS 8	75	A-TNC-25C16-75-A	1 A	A-EIN-C-1-C61	
RG-178; RG-196		50	A-TNC-25C18-50-A			
RG-179		75	A-TNC-25C25-75-A			
RG-316		50	50		A-TNC-25C25A-50-A	A-EIN-C-1-641
RG-174; RG-188					A-TNC-25C26-50-A	
RG-187					A-TNC-25C26B-75-A	
FLEX-2	INS 9	75	A-TNC-25C27-75-A	2 B	A-EIN-C-1-931	
FLEX-3			A-TNC-25C35-75-A			
S 0.4/2.5			A-TNC-25C44A-75-A			
FLEX-4			A-TNC-25C45-75-A			
FLEX-5			A-TNC-25C47-75-A			
RG-58; RG-141; RG-303			50			50
RG-142; RG-400	A-TNC-25C50A-50-A					
RG-223	A-TNC-25C54-50-A					
ST-214	A-TNC-25C59-75-A					
FLEX-6	75	75		A-TNC-25C60-75-A		
RG-59				A-TNC-25C61-75-A		
0.8-0.7; 1505A; 9889; VK-6			A-TNC-25C61B-75-A			
LMR-240	50	50	A-TNC-25C61D-50-A			

hembra recta panel crimp
(montaje trasero)
estanco

straight crimp type bulkhead jack
(rear mounting)
waterproof

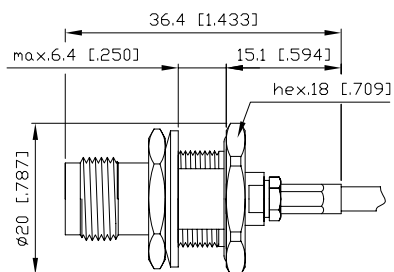

fig.1

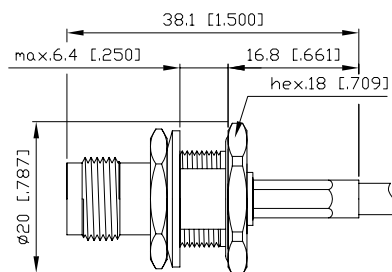

fig.2

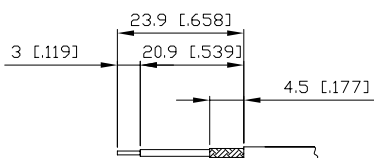

fig.A

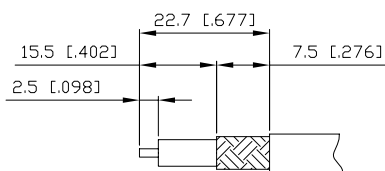
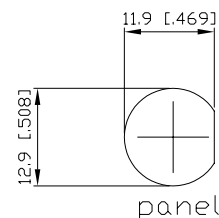

fig.B



CABLE CABLE	INSTRUC. INSTRUC.	Ω	ALFA'R CODE CÓDIGO ALFA'R	FIG. FIG.	CRIMPING TOOL HERRAMIENTA CRIMP	
TX-20	INS 15	75	A-TNC-26C16-75	1 A	A-EIN-C-1-C61	
RG-178; RG-196		50	A-TNC-26C18-50			
RG-179		75	A-TNC-26C25-75			
RG-316		50	A-TNC-26C25A-50			
RG-174; RG-188			A-TNC-26C26-50			
RG-187	INS 9	75	A-TNC-26C26B-75	2 B	A-EIN-C-1-641	
FLEX-2			A-TNC-26C27-75			
FLEX-3			A-TNC-26C35-75			
S 0.4/2.5		50	A-TNC-26C44A-75			
FLEX-4			A-TNC-26C45-75			
FLEX-5			A-TNC-26C47-75			
RG-58; RG-141; RG-303		75	A-TNC-26C50-50			A-EIN-C-1-931
RG-142; RG-400			A-TNC-26C50A-50			
RG-223			A-TNC-26C54-50			
ST-214			A-TNC-26C59-75			
FLEX-6	A-TNC-26C60-75					
RG-59	50	A-TNC-26C61-75	A-EIN-C-1-931 A-EIN-C-1-341			
0.8-0.7; 1505A; 9889; VK-6		A-TNC-26C61B-75				
LMR-240		A-TNC-26C61D-50				

hembra recta panel
aislado crimp
(montaje trasero)
estanco

straight crimp type isolated
bulkhead jack
(rear mounting)
waterproof

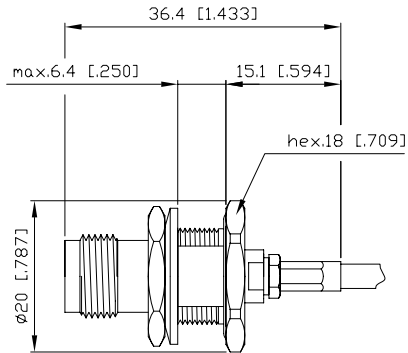

fig.1

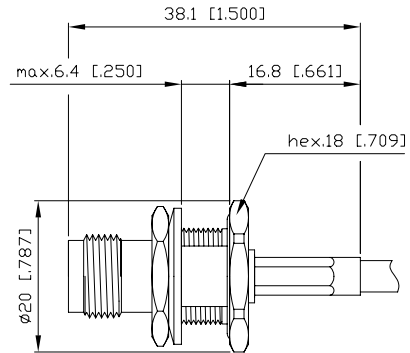

fig.2

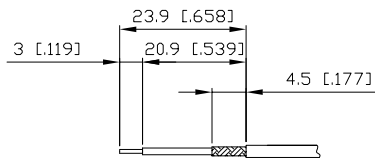

fig.A

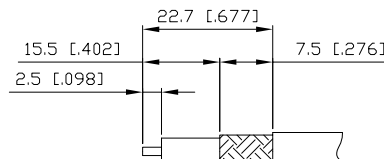
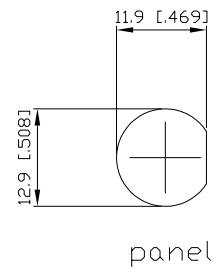

fig.B



panel

CABLE CABLE	NOTE NOTA	INSTRUC. INSTRUC.	Ω	ALFA'R CODE CÓDIGO ALFA'R	FIG. FIG.	CRIMPING TOOL HERRAMIENTA CRIMP
TX-20	metal thread ferrule	INS 15	75	A-TNC-26C16-75-B	1 A	A-EIN-C-1-C61
RG-178; RG-196			50	A-TNC-26C18-50-B		
RG-179			75	A-TNC-26C25-75-B		
RG-316			50	A-TNC-26C25A-50-B		
RG-174; RG-188				A-TNC-26C26-50-B		
RG-187				A-TNC-26C26B-75-B		
FLEX-2				A-TNC-26C27-75-B		
FLEX-3				A-TNC-26C35-75-B		
S 0.4/2.5				A-TNC-26C44A-75-B		
FLEX-4				A-TNC-26C45-75-B		
FLEX-5		A-TNC-26C47-75-B				
RG-58; RG-141; RG-303	casquillo rosca metálico	INS 9	50	A-TNC-26C50-50-B	2 B	A-EIN-C-1-931 A-EIN-C-1-341
RG-142; RG-400			50	A-TNC-26C50A-50-B		
RG-223			50	A-TNC-26C54-50-B		
ST-214			75	A-TNC-26C59-75-B		
FLEX-6			75	A-TNC-26C60-75-B		
RG-59			75	A-TNC-26C61-75-B		
0.8-0.7; 1505A; 9889; VK-6			75	A-TNC-26C61B-75-B		
LMR-240			50	A-TNC-26C61D-50-B		

hembra recta panel crimp
(montaje trasero)
estanco

straight crimp type bulkhead jack
(rear mounting)
waterproof

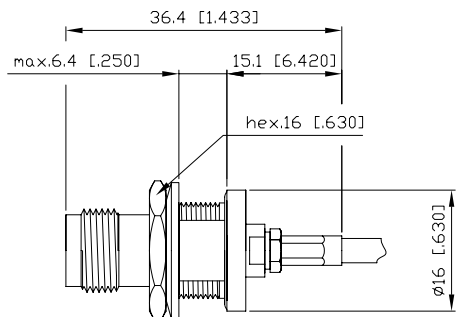

fig.1

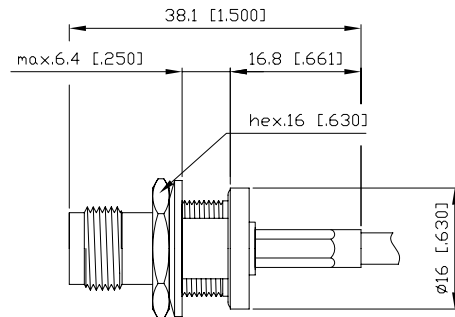

fig.2

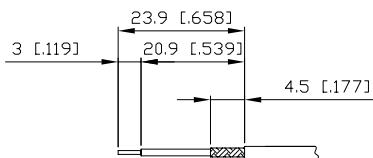

fig.A

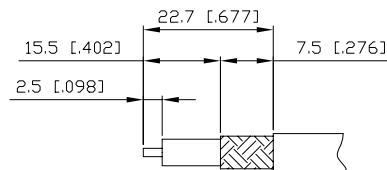
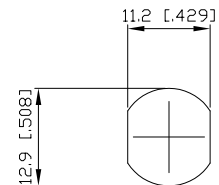

fig.B



panel

CABLE CABLE	INSTRUC. INSTRUC.	Ω	ALFA'R CODE CÓDIGO ALFA'R	FIG. FIG.	CRIMPING TOOL HERRAMIENTA CRIMP
TX-20	INS 8	75	A-TNC-26C16-75-A	1	A-EIN-C-1-C61
RG-178; RG-196		50	A-TNC-26C18-50-A		
RG-179		75	A-TNC-26C25-75-A		A-EIN-C-1-641
RG-316		50	A-TNC-26C25A-50-A		
RG-174; RG-188			A-TNC-26C26-50-A		
RG-187		A-TNC-26C26B-75-A			
FLEX-2	INS 9	75	A-TNC-26C27-75-A	2	A-EIN-C-1-1931
FLEX-3			A-TNC-26C35-75-A		
S 0.4/2.5			A-TNC-26C44A-75-A		
FLEX-4		50	A-TNC-26C45-75-A		A-EIN-C-1-931 A-EIN-C-1-341
FLEX-5			A-TNC-26C47-75-A		
RG-58; RG-141; RG-303			A-TNC-26C50-50-A		
RG-142; RG-400	50	A-TNC-26C50A-50-A			
RG-223		A-TNC-26C54-50-A			
ST-214	75	A-TNC-26C59-75-A			
FLEX-6		A-TNC-26C60-75-A			
RG-59		A-TNC-26C61-75-A			
0.8-0.7; 1505A; 9889; VK-6		A-TNC-26C61B-75-A			
LMR-240	50	A-TNC-26C61D-50-A			

hembra recta panel crimp
(montaje trasero)
estanco

straight crimp type bulkhead jack
(rear mounting)
waterproof

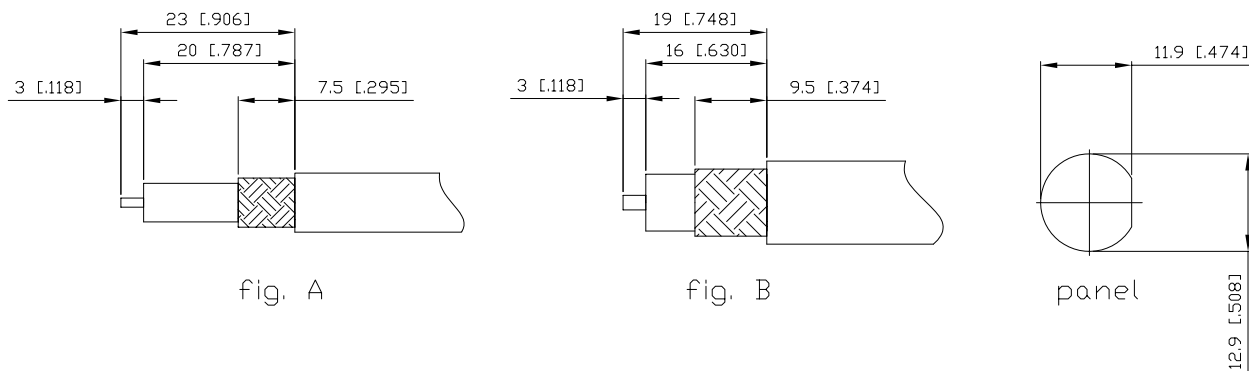
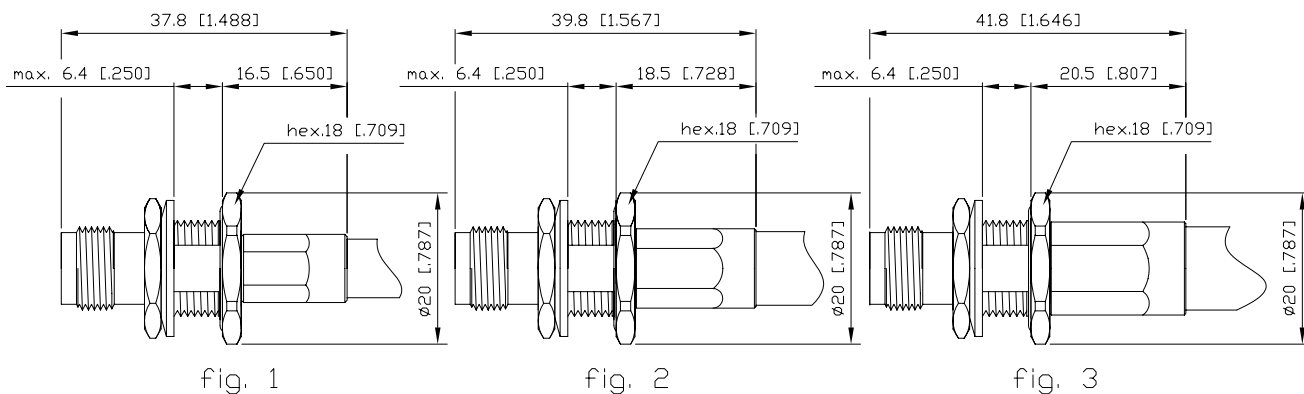

CABLE CABLE	INSTRUC. INSTRUC.	Ω	ALFA'R CODE CÓDIGO ALFA'R	FIG. FIG.	CRIMPING TOOL HERRAMIENTA CRIMP	
TF-2240 (TFC-T10)	INS 9	75	A-TNC-26C67-75	1	A	
RG-6 CATV			A-TNC-26C68-75			
FLEX-7			A-TNC-26C74-75			
RG-6 MIL			A-TNC-26C84-75			
1.0/6.6/8.8			A-TNC-26C88-75			
RG-393	INS 10	50	A-TNC-26C99-50	3	B	
RG-8			A-TNC-26C101-50			
CATV 14/8		75	A-TNC-26C102-75			
RG-213		50	A-TNC-26C103-50			
RG-11		75	A-TNC-26C103A-75			
LMR-400; RG-165		50	A-TNC-26C103D-50			
RG-214			A-TNC-26C108-50			
RG-216			75			A-TNC-26C108A-75
RG-225			50			A-TNC-26C109-50

hembra recta panel crimp
(montaje trasero)
estanco

straight crimp type bulkhead jack
(rear mounting)
waterproof

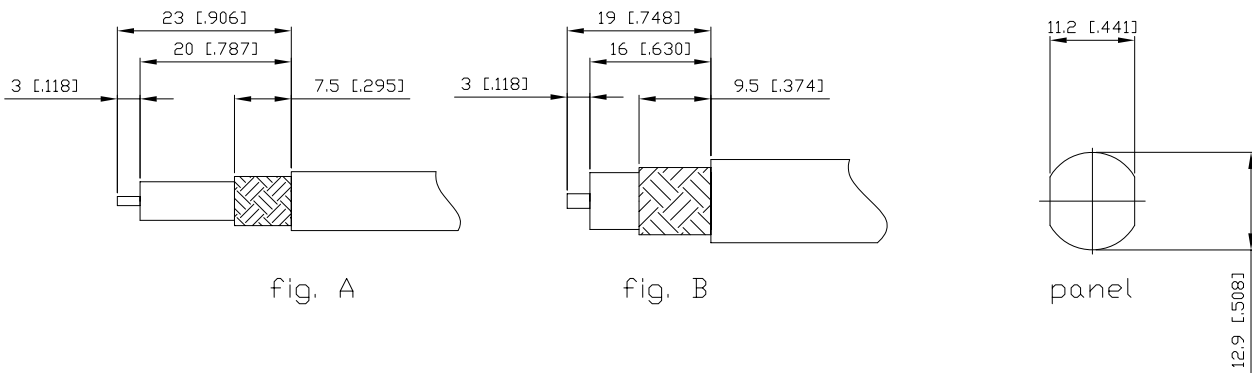
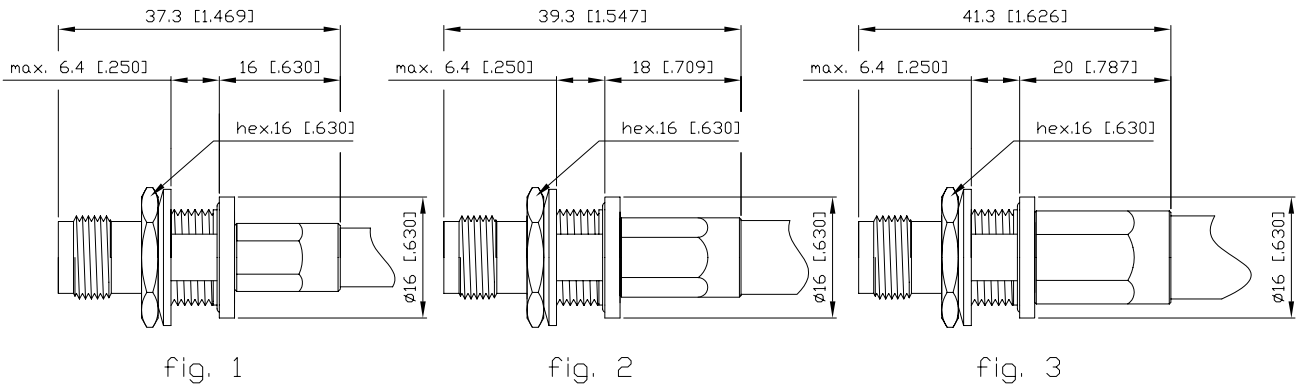

CABLE CABLE	INSTRUC. INSTRUC.	Ω	ALFA'R CODE CÓDIGO ALFA'R	FIG. FIG.	CRIMPING TOOL HERRAMIENTA CRIMP
TF-2240 (TFC-T10)	INS 9	75	A-TNC-26C67-75-A	1	A
RG-6 CATV			A-TNC-26C68-75-A		
FLEX-7			A-TNC-26C74-75-A	2	B
RG-6 MIL			A-TNC-26C84-75-A		
1.0/6.6/8.8			A-TNC-26C88-75-A		
RG-393	INS 10	50	A-TNC-26C99-50-A	3	B
RG-8			A-TNC-26C101-50-A		
CATV 14/8		75	A-TNC-26C102-75-A		
RG-213		50	A-TNC-26C103-50-A		
RG-11		75	A-TNC-26C103A-75-A		
LMR-400; RG-165		50	A-TNC-26C103D-50-A		
RG-214		50	A-TNC-26C108-50-A		
RG-216		75	A-TNC-26C108A-75-A		
RG-225		50	A-TNC-26C109-50-A		

hembra recta panel prensaestopas
(montaje trasero)
estanco

straight clamp type bulkhead jack
(rear mounting)
waterproof

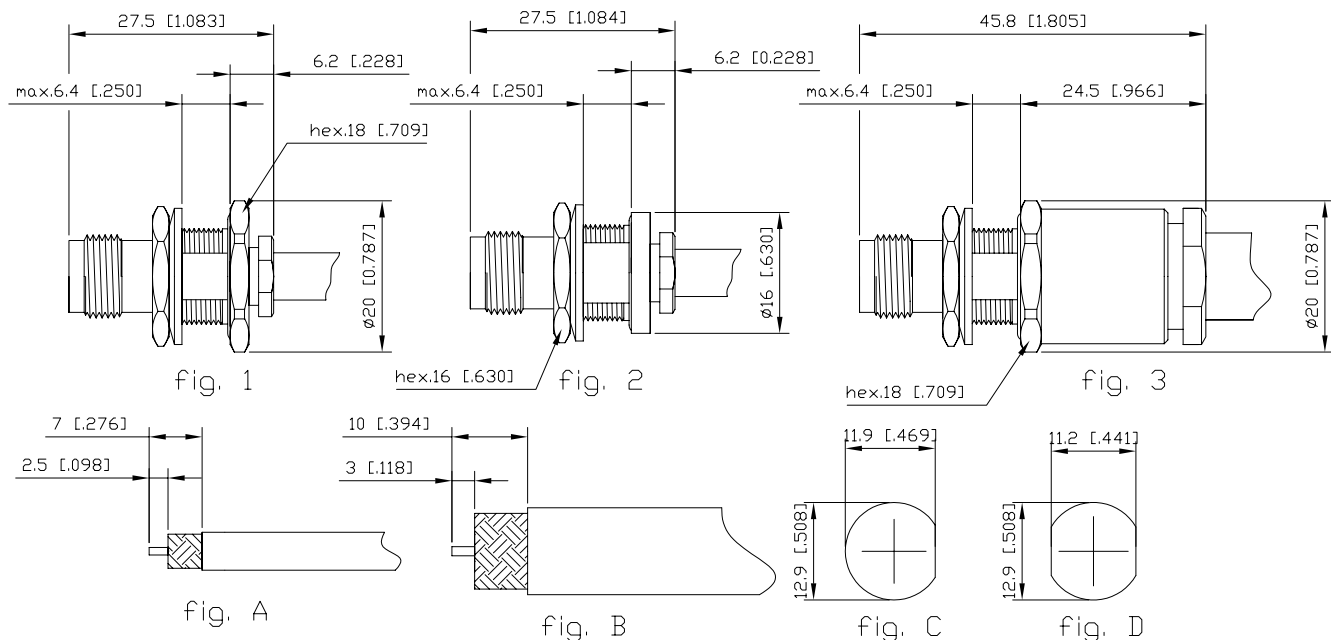

CABLE CABLE	INSTRUC. INSTRUC.	Ω	ALFA'R CODE CÓDIGO ALFA'R	FIG. FIG.	
RG-179	INS 12	75	A-TNC-26P25-75	1	C
			A-TNC-26P25-75-A	2	D
RG-316		50	A-TNC-26P25A-50	1	C
			A-TNC-26P25A-50-A	2	D
RG-174; RG-188			A-TNC-26P26-50	1	C
			A-TNC-26P26-50-A	2	D
RG-187		75	A-TNC-26P26B-75	1	C
			A-TNC-26P26B-75-A	2	D
RG-58; RG-141; RG-303		50	A-TNC-26P50-50	1	C
			A-TNC-26P50-50-A	2	D
RG-142; RG-400			A-TNC-26P50A-50	1	C
			A-TNC-26P50A-50-A	2	D
ST-214		75	A-TNC-26P59-75	1	C
			A-TNC-26P59-75-A	2	D
FLEX-6		75	A-TNC-26P60-75	1	C
			A-TNC-26P60-75-A	2	D
RG-59			A-TNC-26P61-75	1	C
			A-TNC-26P61-75-A	2	D
0.8-0.7; 1505A; 9889; VK-6		50	A-TNC-26P61B-75	1	C
			A-TNC-26P61B-75-A	2	D
LMR-240	A-TNC-26P61D-50		1	C	
	A-TNC-26P61D-50-A		2	D	
RG-8	INS 13	75	A-TNC-26P101-50	3	B
CATV14/8			A-TNC-26P102-75		
RG-213		50	A-TNC-26P103-50		
RG-11		75	A-TNC-26P103A-75		
LMR-400; RG-165		50	A-TNC-26P103D-50		
RG-214		50	A-TNC-26P108-50		
RG-216		75	A-TNC-26P108A-75		
RG-225		50	A-TNC-26P109-50		

**Conectores panel con
contacto central soldable**

macho panel

*Receptacle connectors with
solder inner contact*

bulkhead plug receptacle

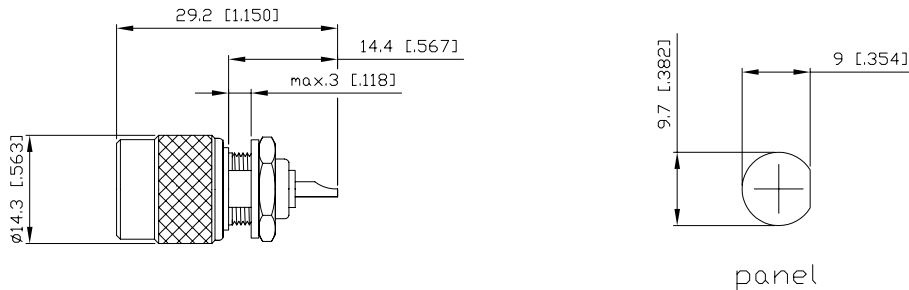

panel

NOTE NOTA	Ω	ALFA'R CODE CÓDIGO ALFA'R	SOLDER TAG TERMINAL MASA
<i>front mounting</i> montaje frontal	50	A-TNC-15TF-50	A-ACC-TM-100
	75	A-TNC-15TF-75	

hembra panel

bulkhead jack receptacle

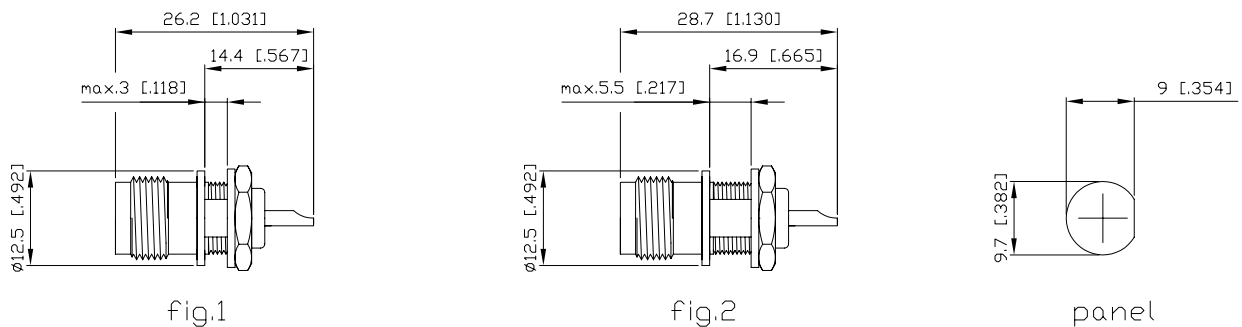

fig.1

fig.2

panel

NOTE NOTA	Ω	ALFA'R CODE CÓDIGO ALFA'R	FIG. FIG.	SOLDER TAG TERMINAL MASA
<i>front mounting</i> montaje frontal	50	A-TNC-25TF-50	1	A-ACC-TM-100
	75	A-TNC-25TF-75		
	50	A-TNC-25TF-50-A	2	
	75	A-TNC-25TF-75-A		

hembra panel

jack receptacle

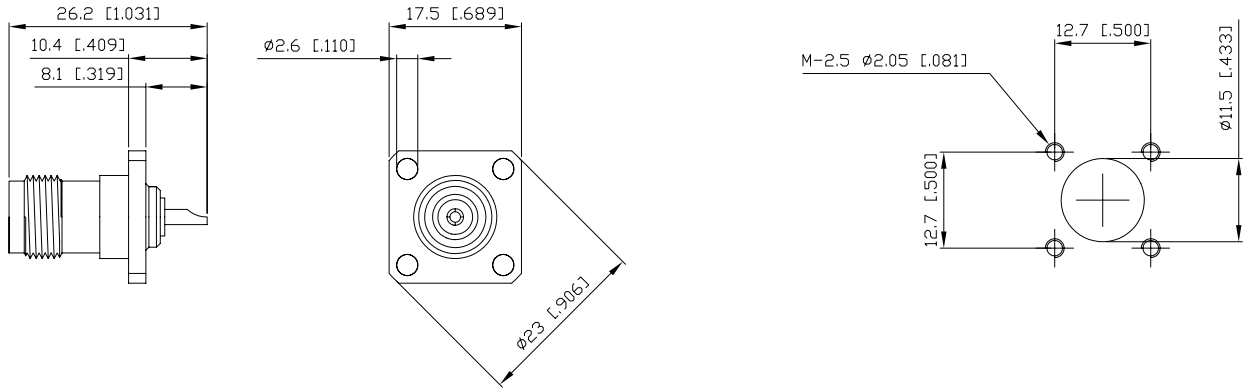

NOTE NOTA	Ω	ALFA'R CODE CÓDIGO ALFA'R	SOLDER TAG TERMINAL MASA
square standard flange (4 holes) pletina cuadrada standard (4 taladros)	50	A-TNC-22TF-50	A-ACC-TM-030
	75	A-TNC-22TF-75	

hembra panel
estanco

bulkhead jack receptacle
waterproof

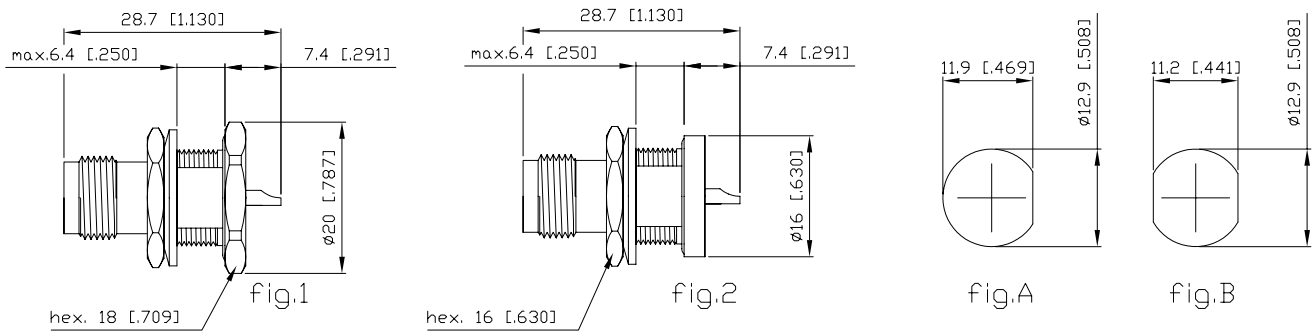

NOTE NOTA	Ω	ALFA'R CODE CÓDIGO ALFA'R	FIG. FIG.
rear mounting montaje trasero	50	A-TNC-26TF-50	1 A
	75	A-TNC-26TF-75	
	50	A-TNC-26TF-50-A	2 B
	75	A-TNC-26TF-75-A	

Conectores para montar en circuito impreso
hembra base

Connectors for printed circuit board mounting
jack receptacle

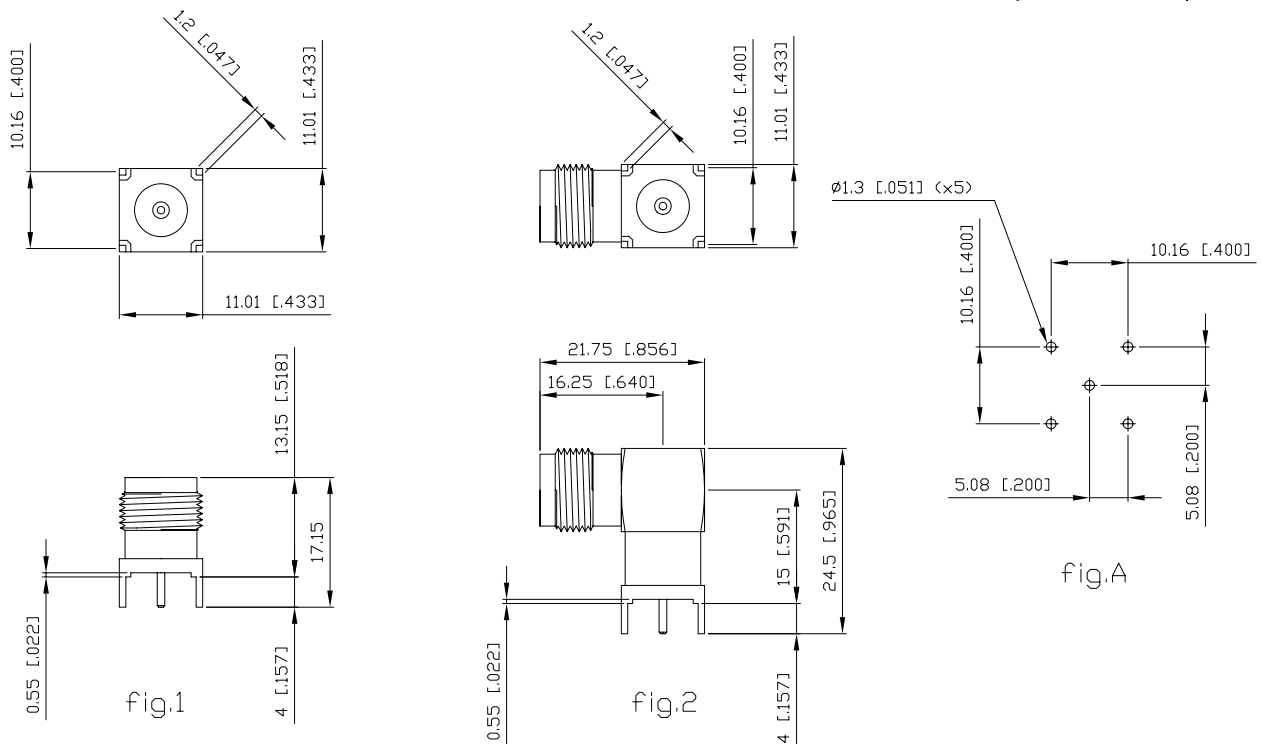

NOTE NOTA	Ω	ALFA'R CODE CÓDIGO ALFA'R	FIG. FIG.
straight jack hembra recta	50	A-TNC-22CI-50	1
right angle jack (90°) hembra en angulo recto (90°)		A-TNC-23CI-50	2

Adaptadores
prolongación

Adaptors
prolongation

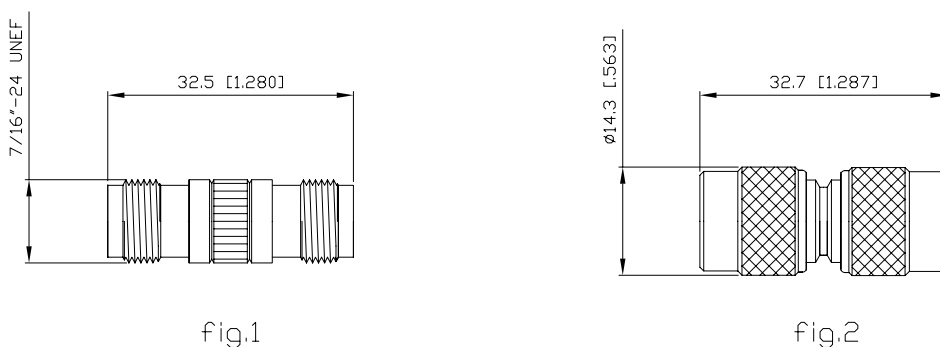

NOTE NOTA	Ω	ALFA'R CODE CÓDIGO ALFA'R	FIG. FIG.
straight jack-jack recto hembra-hembra	50	A-TNC-00-50	1
	75	A-TNC-00-75	
straight plug-plug recto macho-macho	50	A-TNC-03-50	2
	75	A-TNC-03-75	

pasamuros hembra-hembra
estanco

*bulkhead jack-jack
waterproof*

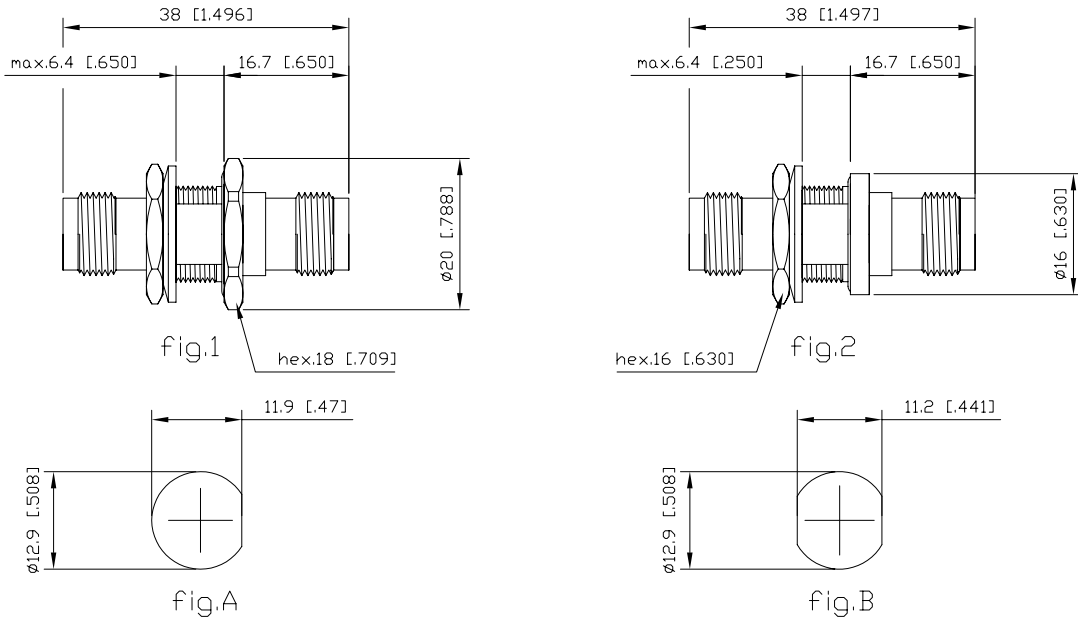

NOTE NOTA	Ω	ALFA'R CODE CODIGO ALFA'R	FIG. FIG.
jack-jack hex.18mm hembra-hembra exa.18mm	50	A-TNC-02-50	1 A
	75	A-TNC-02-75	
jack-jack \varnothing 16mm hembra-hembra \varnothing 16mm	50	A-TNC-02-50-A	2 B
	75	A-TNC-02-75-A	

adaptador a 90°

90° adapter

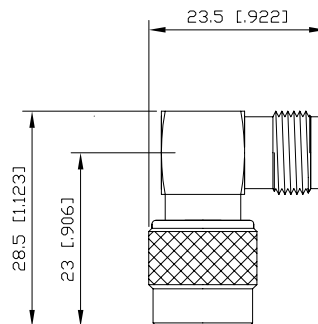

NOTE NOTA	Ω	ALFA'R CODE CODIGO ALFA'R
plug-jack macho-hembra	50	A-TNC-31-50
	75	A-TNC-31-75

adaptador en T

T adapter

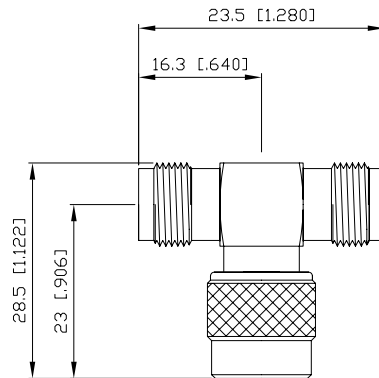

NOTE NOTA	Ω	ALFA'R CODE CÓDIGO ALFA'R	
<i>jack-plug-jack</i> hembra-macho-hembra	50	A-TNC-40-50	
	75	A-TNC-40-75	

adaptador en T

T adapter

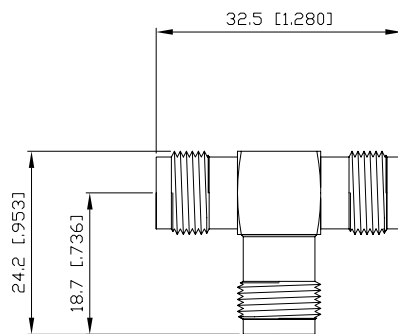

NOTE NOTA	Ω	ALFA'R CODE CÓDIGO ALFA'R	
<i>jack-jack-jack</i> hembra-hembra-hembra	50	A-TNC-44-50	
	75	A-TNC-44-75	

Protectores

tapón para hembra

*Protectives
cap for jack*

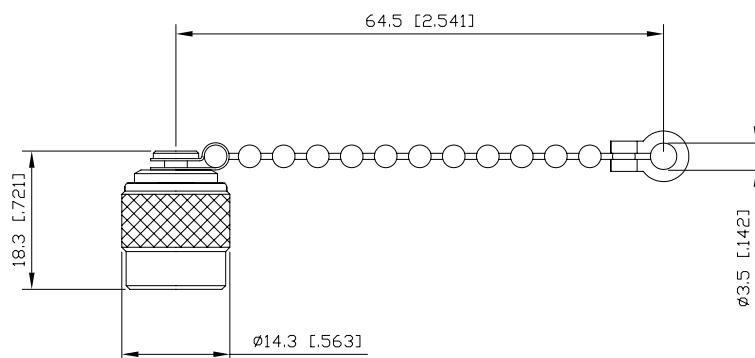

NOTE NOTA		Ω	ALFA'R CODE CÓDIGO ALFA'R
<i>protective cap</i> tapón protector	<i>without chain</i> sin cadena		A-TNC-51-00-A
<i>protective cap</i> tapón protector	<i>with chain</i> con cadena		A-TNC-51-00
<i>short circuit cap</i> tapón corto circuito	<i>without chain</i> sin cadena	50	A-TNC-53-50-A
		75	A-TNC-53-75-A
<i>short circuit cap</i> tapón corto circuito	<i>with chain</i> con cadena	50	A-TNC-53-50
		75	A-TNC-53-75

tapón para macho

cap for plug

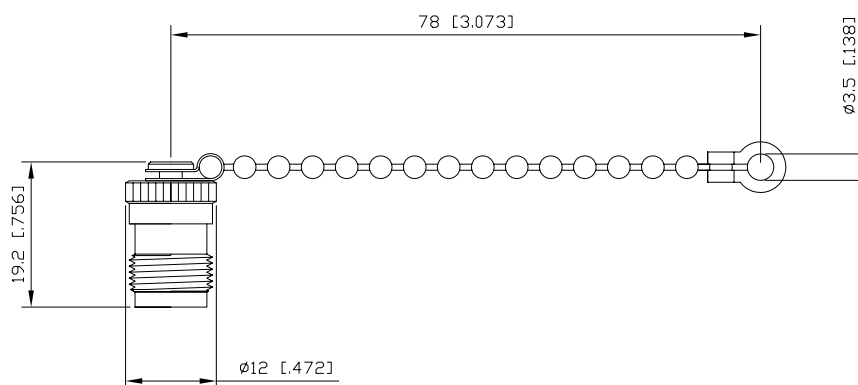

NOTE NOTA		Ω	ALFA'R CODE CODIGO ALFA'R
<i>protective cap</i> tapón protector	<i>without chain</i> sin cadena		A-TNC-50-00-A
<i>protective cap</i> tapón protector	<i>with chain</i> con cadena		A-TNC-50-00
<i>short circuit cap</i> tapón corto circuito	<i>without chain</i> sin cadena	50	A-TNC-52-50-A
		75	A-TNC-52-75-A
<i>short circuit cap</i> tapón corto circuito	<i>with chain</i> con cadena	50	A-TNC-52-50
		75	A-TNC-52-75

Terminaciones
macho

Terminations
plug

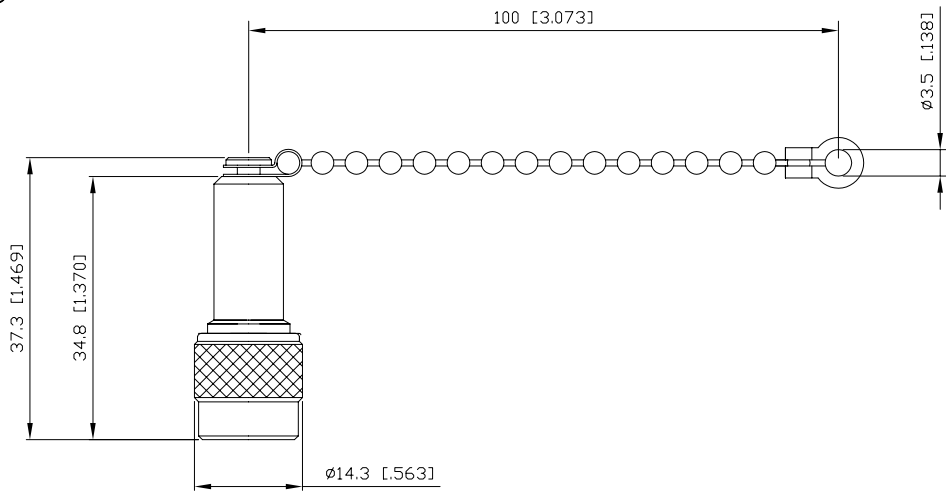

NOTE NOTA	IMPEDANCE IMPEDANCIA	POWER POTENCIA	ALFA'R CODE CÓDIGO ALFA'R	VSWR	
				300MHz	1000MHz
without chain sin cadena	50 Ω ± 1 Ω	0.5 Watt	A-TNC-54-50	≤1.05	≤ 1.1
with chain con cadena			A-TNC-54-50-A		
without chain sin cadena	75 Ω ± 1 Ω		A-TNC-54-75		
with chain con cadena			A-TNC-54-75-A		

hembra

jack

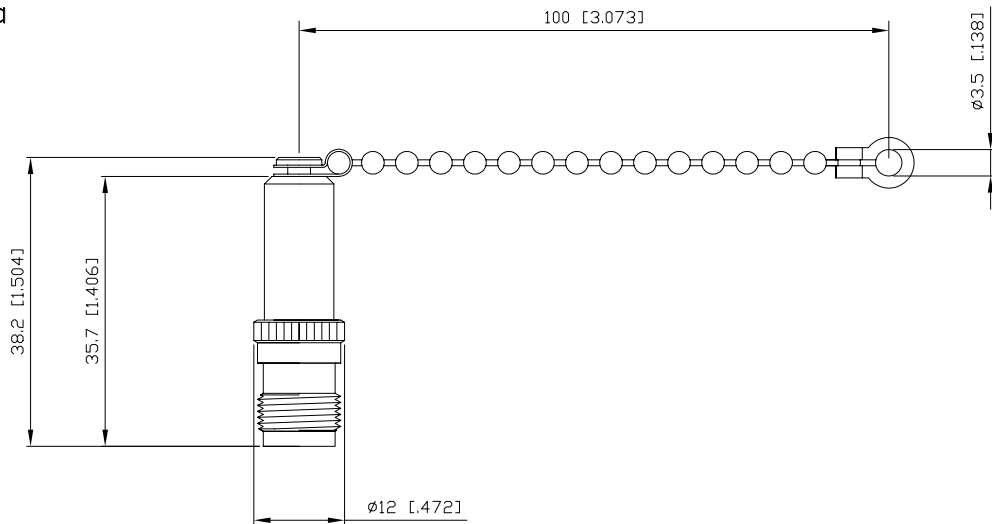

NOTE NOTA	IMPEDANCE IMPEDANCIA	POWER POTENCIA	ALFA'R CODE CÓDIGO ALFA'R	VSWR	
				300MHz	1000MHz
without chain sin cadena	50 Ω ± 1 Ω	0.5 Watt	A-TNC-55-50	≤1.05	≤ 1.1
with chain con cadena			A-TNC-55-50-A		
without chain sin cadena	75 Ω ± 1 Ω		A-TNC-55-75		
with chain con cadena			A-TNC-55-75-A		

**DIMENSIONES INTERCONEXIÓN
CONTACTO CENTRAL INVERTIDO**

***INTERFACE DIMENSIONS
REVERSE INNER CONTACT***

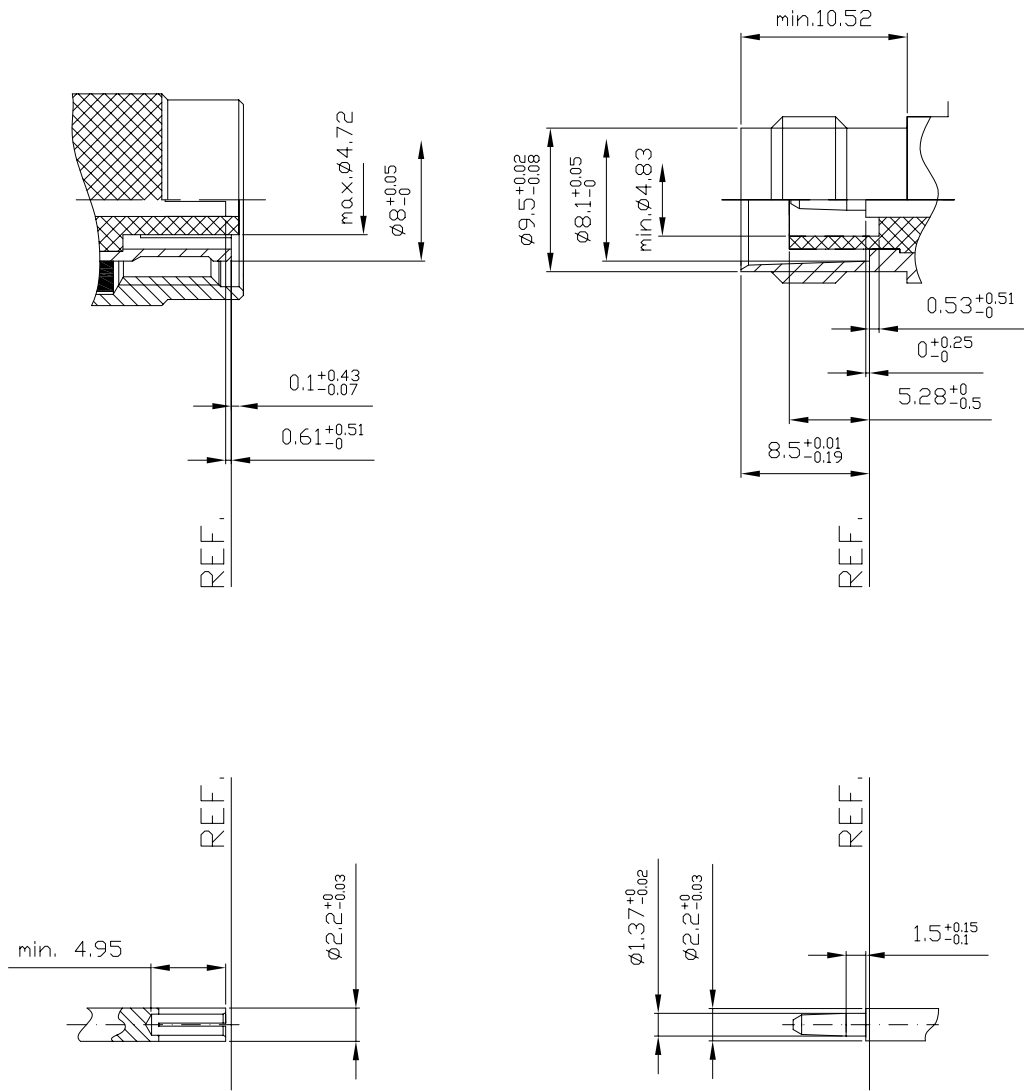

Conectores para cable flexible

Connectors for flexible cable

CONTACTO CENTRAL INVERTIDO
recto crimp

REVERSE INNER CONTACT
straight crimp type

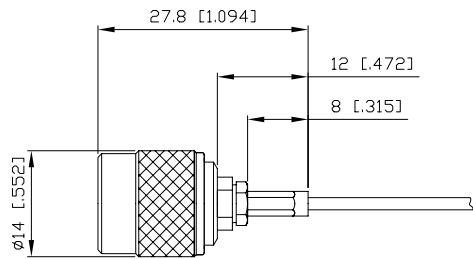

fig. 1

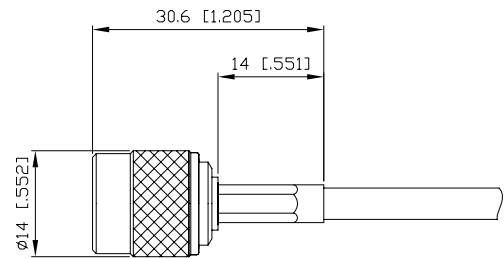

fig. 2

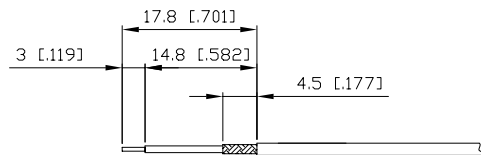

fig. A

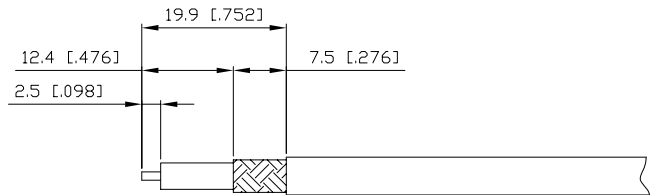

fig. C

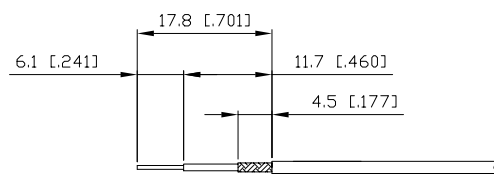

fig. B

CABLE CABLE	INSTRUC. INSTRUC.	Ω	ALFA'R CODE CÓDIGO ALFA'R	FIG. FIG.	CRIMPING TOOL HERRAMIENTA CRIMP	
RG-178; RG-196	INS 8	50	A-TNCI-20C18-50	1	A	A-EIN-C-1-C61
RG-316			A-TNCI-20C25A-50	1	B	A-EIN-C-1-641
RG-174; RG-188			A-TNCI-20C26-50			
RG-58; RG-141; RG-303	INS 9		A-TNCI-20C50-50	2	C	A-EIN-C-1-931 A-EIN-C-1-341
RG-142; RG-400			A-TNCI-20C50A-50			
RG-223			A-TNCI-20C54-50			
LMR-240		A-TNCI-20C61D-50				

CONTACTO CENTRAL INVERTIDO
recto crimp

REVERSE INNER CONTACT
straight crimp type

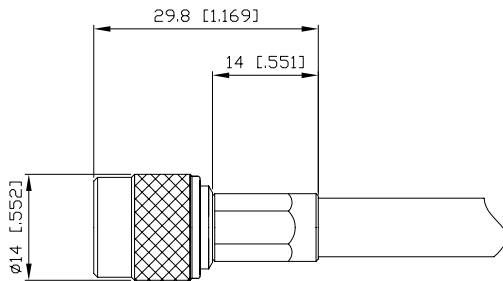

fig.1

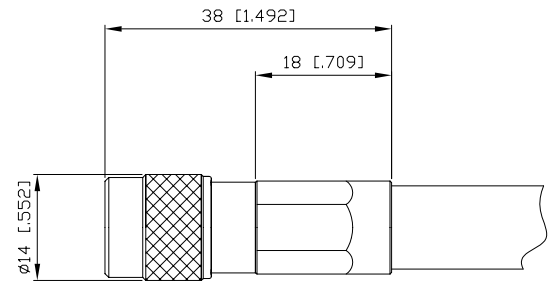

fig.2

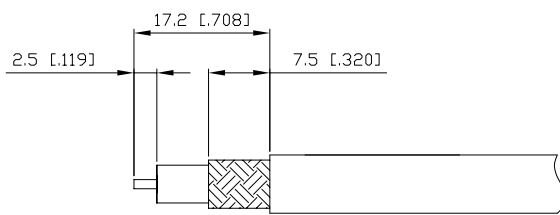

fig.A

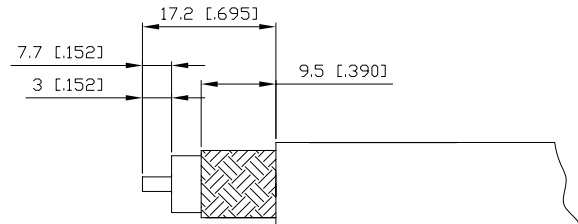
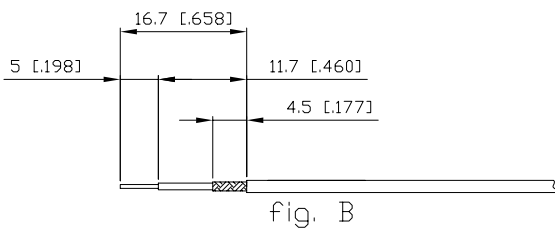
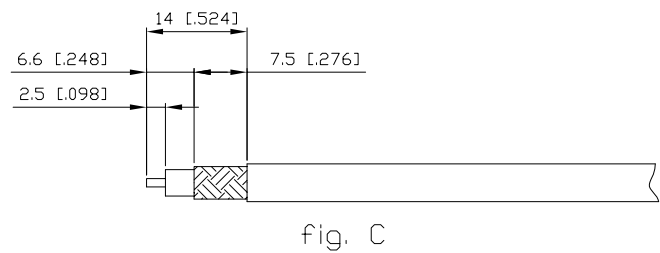
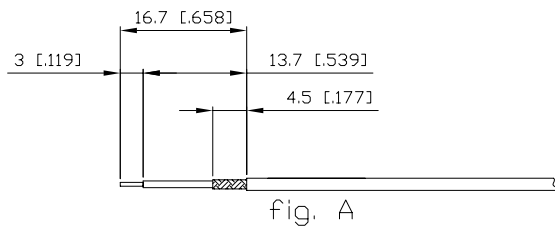
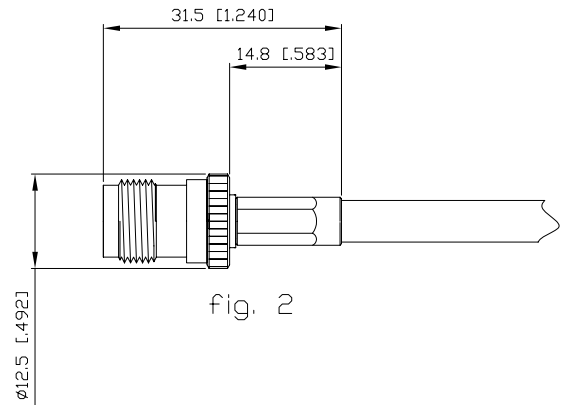
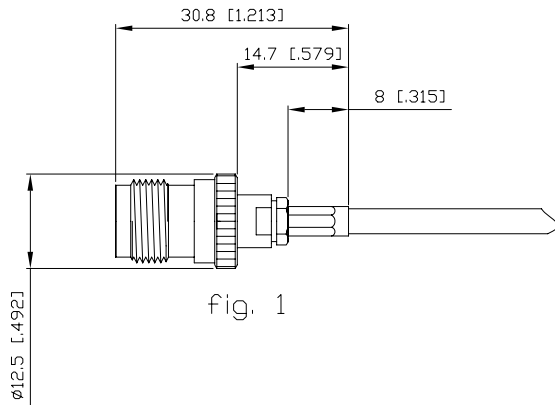

fig.B

CABLE	INSTRUC.	Ω	ALFA'R CODE	FIG.	CRIMPING TOOL
CABLE	INSTRUC.		CÓDIGO ALFA'R	FIG.	HERRAMIENTA CRIMP
5D-FB	INS 9	50	A-TNCI-20C76-50	1 A	A-EIN-C-1-51
RG-393	INS 10		A-TNCI-20C99-50	2 B	A-EIN-C-2-D2
RG-8			A-TNCI-20C101-50		A-EIN-C-2-D2
RG-213			A-TNCI-20C103-50		A-EIN-C-2-D2
LMR-400; RG-165			A-TNCI-20C103D-50		A-EIN-C-2-D2
RG-214			A-TNCI-20C108-50		A-EIN-C-2-D2
RG-225			A-TNCI-20C109-50		A-EIN-C-2-D2

CONTACTO CENTRAL INVERTIDO
recto crimp

REVERSE INNER CONTACT
straight crimp type



CABLE CABLE	INSTRUC. INSTRUC.	Ω	ALFA'R CODE CÓDIGO ALFA'R	FIG. FIG.	CRIMPING TOOL HERRAMIENTA CRIMP	
RG-178; RG-196	INS 8	50	A-TNCI-10C18-50	1	A	A-EIN-C-1-C61
RG-316			A-TNCI-10C25A-50		B	A-EIN-C-1-641
RG-174; RG-188			A-TNCI-10C26-50	2	C	A-EIN-C-1-931 A-EIN-C-1-341
RG-58; RG-141; RG-303	A-TNCI-10C50-50					
RG-142; RG-400	A-TNCI-10C50A-50					
RG-223	A-TNCI-10C54-50					
LMR-240	INS 9	A-TNCI-10C61D-50				

CONTACTO CENTRAL INVERTIDO
recto panel crimp
(montaje frontal)

REVERSE INNER CONTACT
straight crimp type bulkhead
(front mounting)

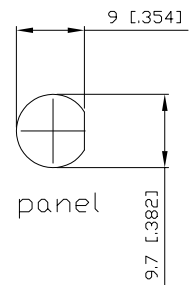
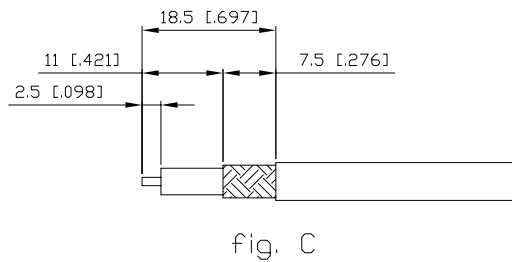
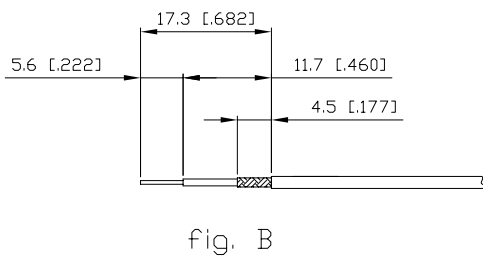
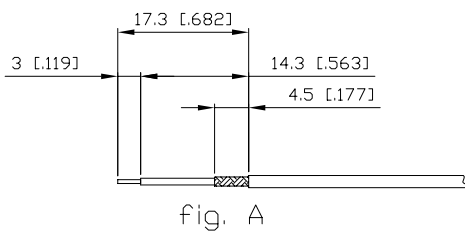
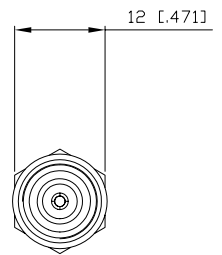
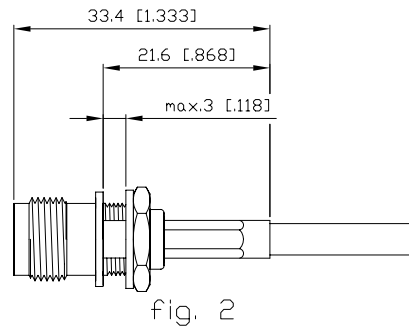
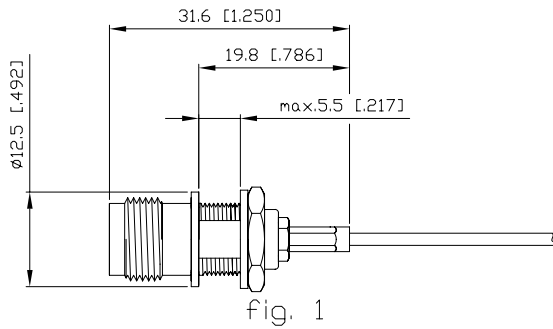

CABLE CABLE	INSTRUC. INSTRUC.	Ω	ALFA'R CODE CÓDIGO ALFA'R	FIG. FIG.	CRIMPING TOOL HERRAMIENTA CRIMP
RG-178; RG-196	INS 8	50	A-TNCI-15C18-50	1	A-EIN-C-1-C61
RG-316			A-TNCI-15C25A-50		A-EIN-C-1-641
RG-174; RG-188	INS 9		A-TNCI-15C26-50	2	A-EIN-C-1-931 A-EIN-C-1-341
RG-58; RG-141; RG-303			A-TNCI-15C50-50		
RG-142; RG-400			A-TNCI-15C50A-50		
RG-223			A-TNCI-15C54-50		
LMR-240		A-TNCI-15C61D-50			